

SETTING UP YOUR PHAROS SECURE PRINTING ACCOUNT

BE PREPARED

- HAVE YOUR SUNY POTSDAM ID WITH THE RFID STICKER APPLIED
- A WAY TO RECORD YOUR PERSONALLY ASSIGNED CODE

OPEN THE PHAROS SECURE RELEASE SETUP GUIDE

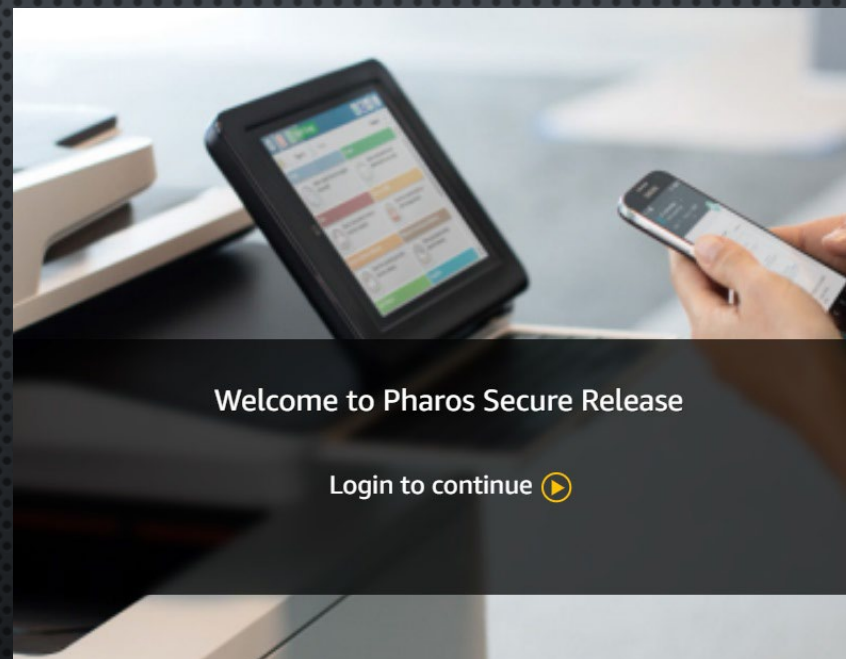

Welcome to Pharos Secure Release

Login to continue ▶

PHAROS SECURE RELEASE SETUP GUIDE

CLOSE THE BROWSER TAB AS SUGGESTED

Authenticated successfully



You may close this browser tab.

PHAROS SECURE RELEASE SETUP GUIDE

- Remember this code, you will need it.
- This code is like a password- Do not share it with anyone.
- Click “Continue” and this window will close.

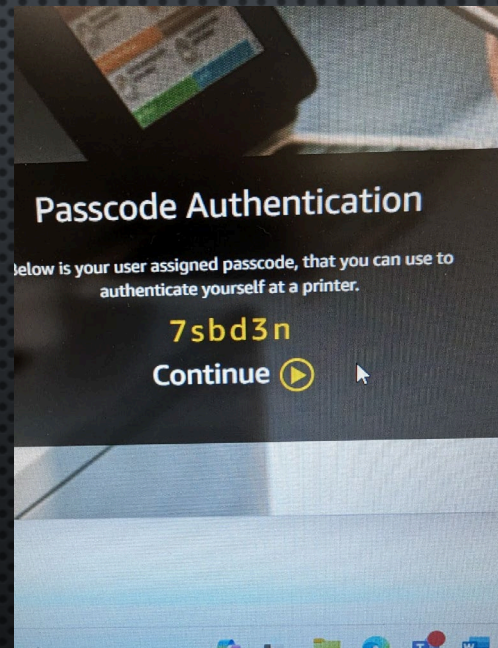

OPEN THE PHAROS SECURE RELEASE SETUP GUIDE

- Select “Keyboard Login”
Always do this one first because this step registers the Passcode you just received. You will need that to register the other methods

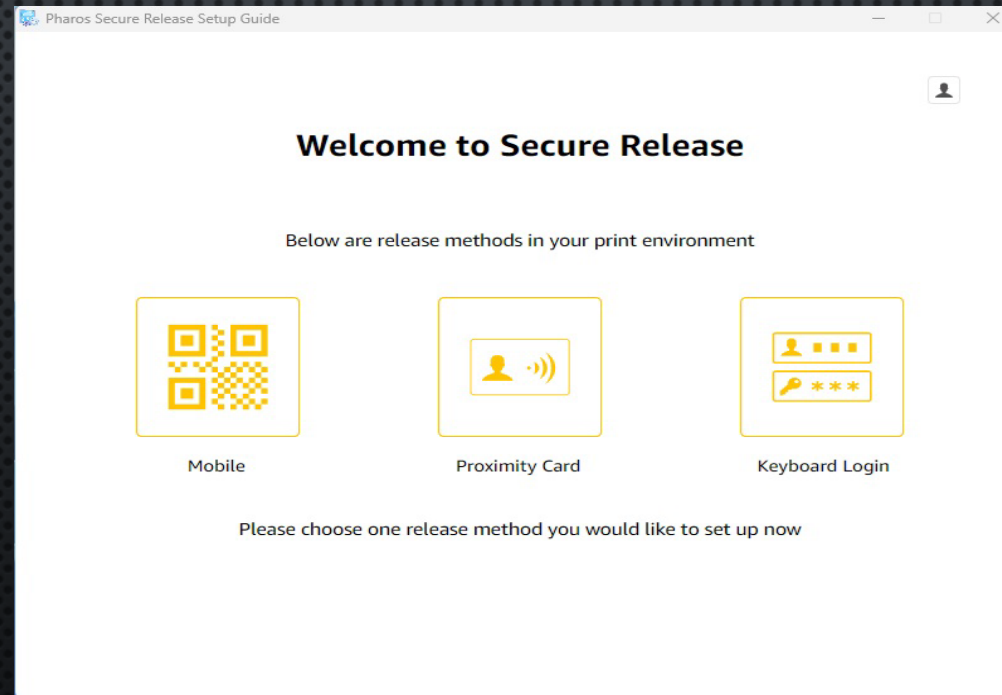

PHAROS SECURE RELEASE SETUP GUIDE

- Click “Start”

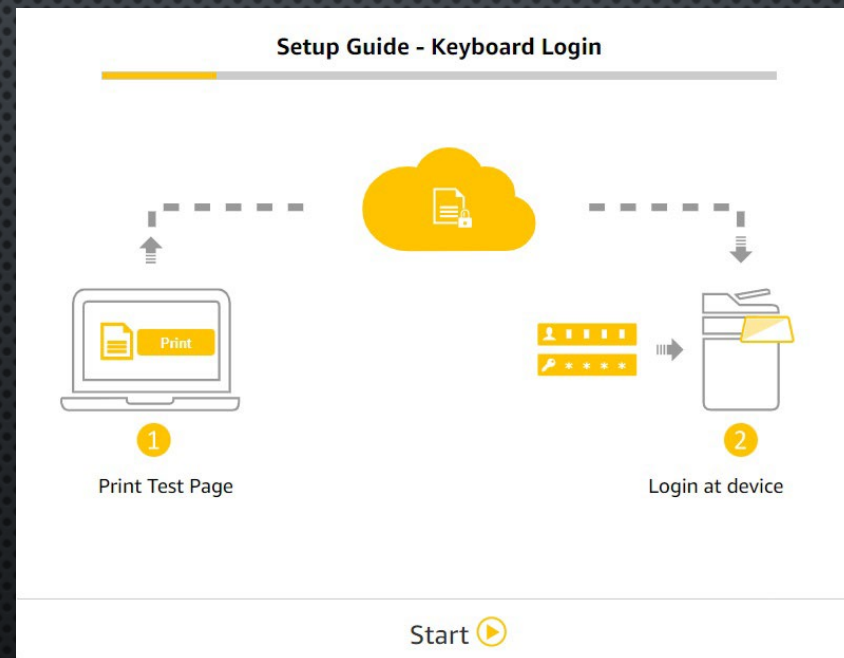

PHAROS SECURE RELEASE SETUP GUIDE

- Make certain the “Make Pharos Secure Printer your default printer” box is checked
- Click “Print test page”

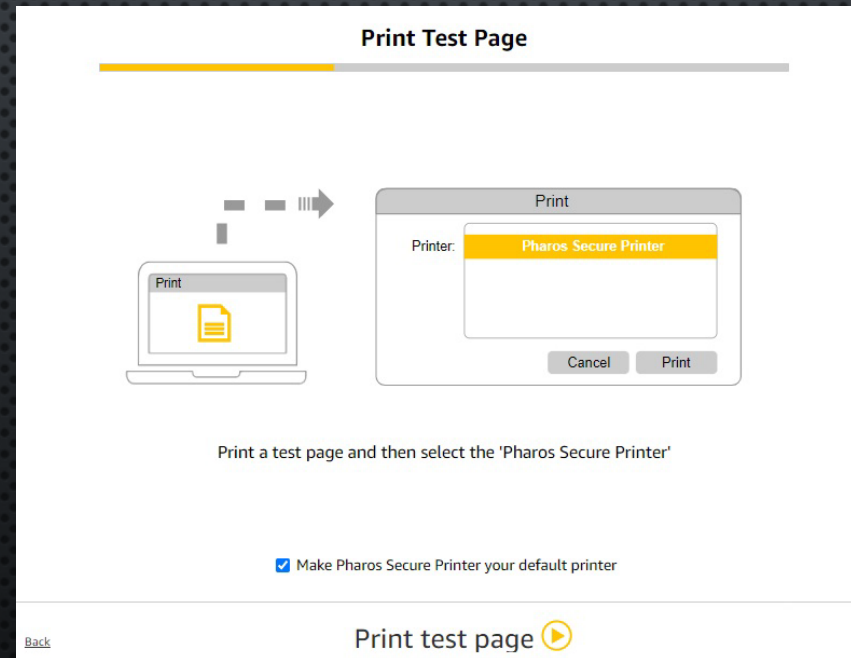

PHAROS SECURE RELEASE SETUP GUIDE

- Make certain “Pharos Secure Printer” is selected
- Click “Print” – This print window will then close

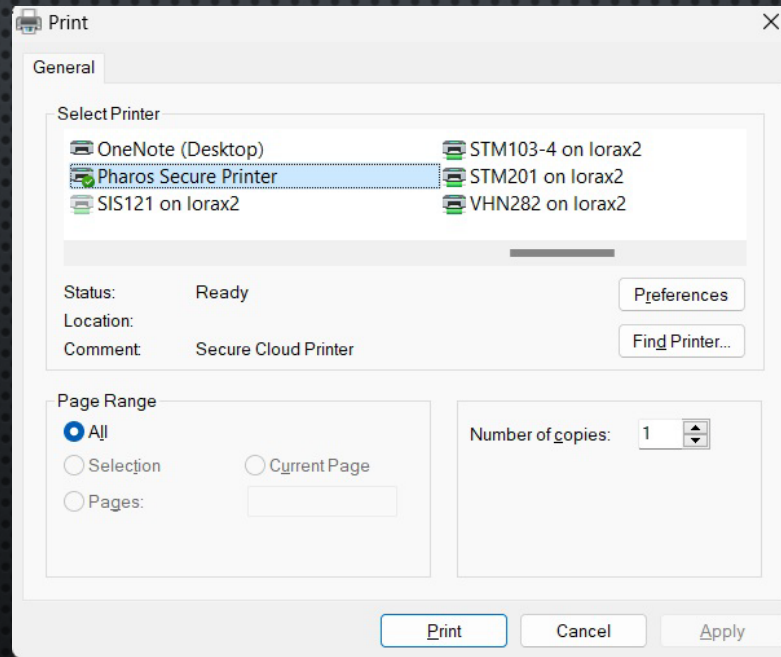

PHAROS SECURE RELEASE SETUP GUIDE

- Click “Next”

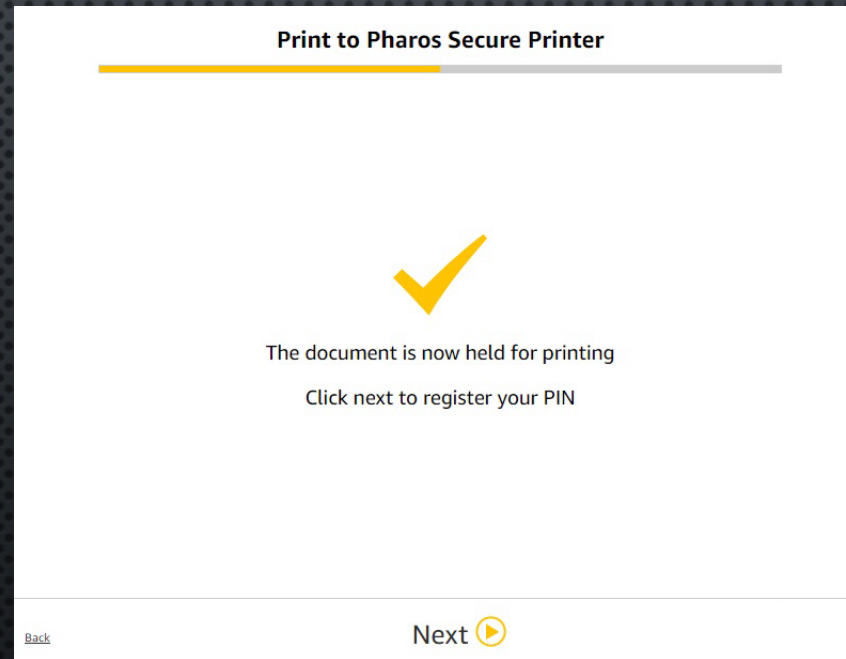

PHAROS SECURE RELEASE SETUP GUIDE

- Click “Next”

Register your PIN

Register your PIN at any secure printer by entering your network ID and password when prompted. Once registered, you can release your test page and you are ready to print jobs securely.

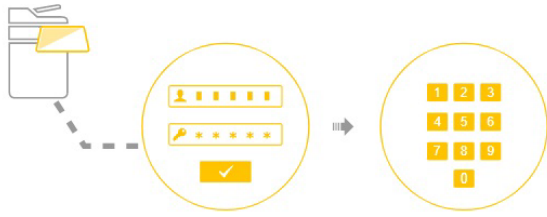

A test page will be printed if your PIN is registered successfully

[Back](#) **Next** 

PHAROS SECURE RELEASE SETUP GUIDE

- Click “Finish”
- Go to the nearest printer with the passcode you were given

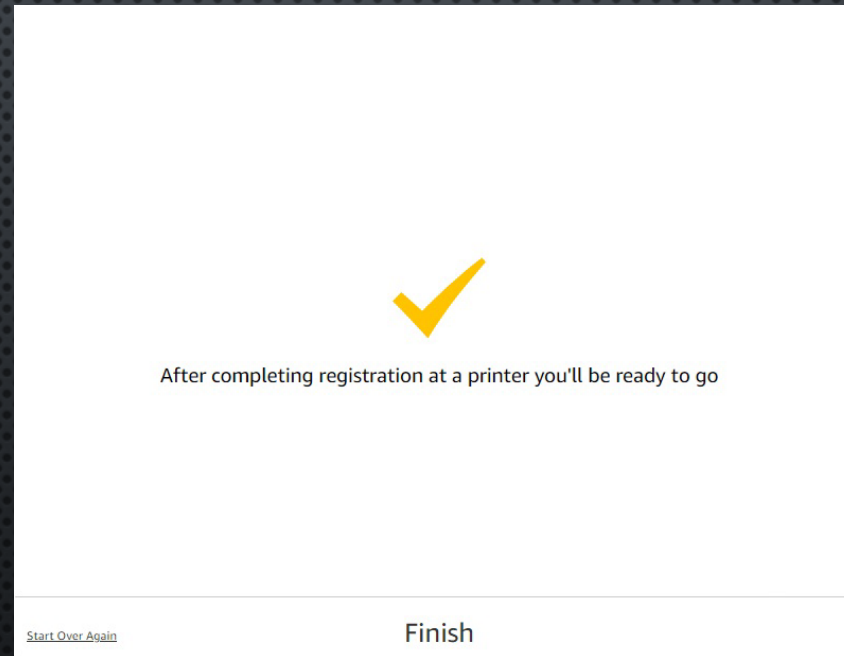

PHAROS SECURE RELEASE SETUP GUIDE

On the printer's touchscreen: *(Wake up the printer by touching the screen or the "Home" icon on the left of the screen)*

- Tap "Passcode Login"
- Tap the line and a virtual keyboard will open to type in the passcode you were given
- The print window will open showing the document in the queue, tap "Print All"

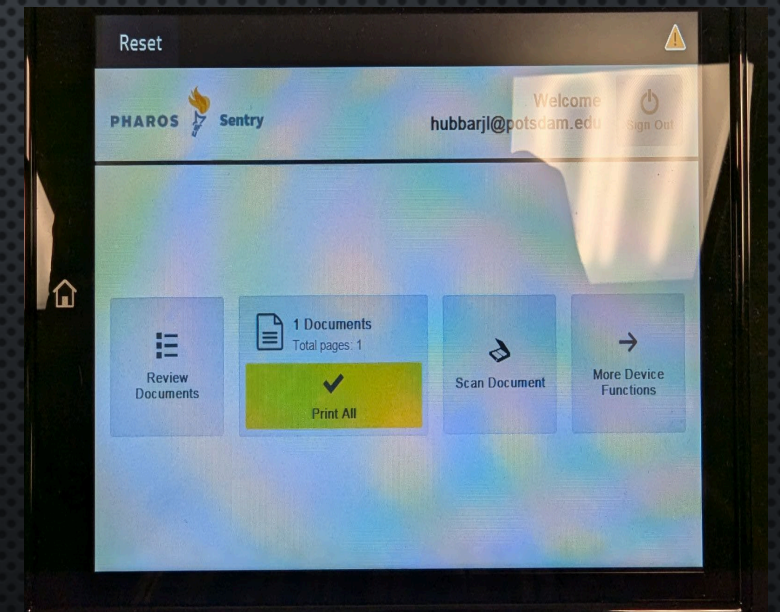
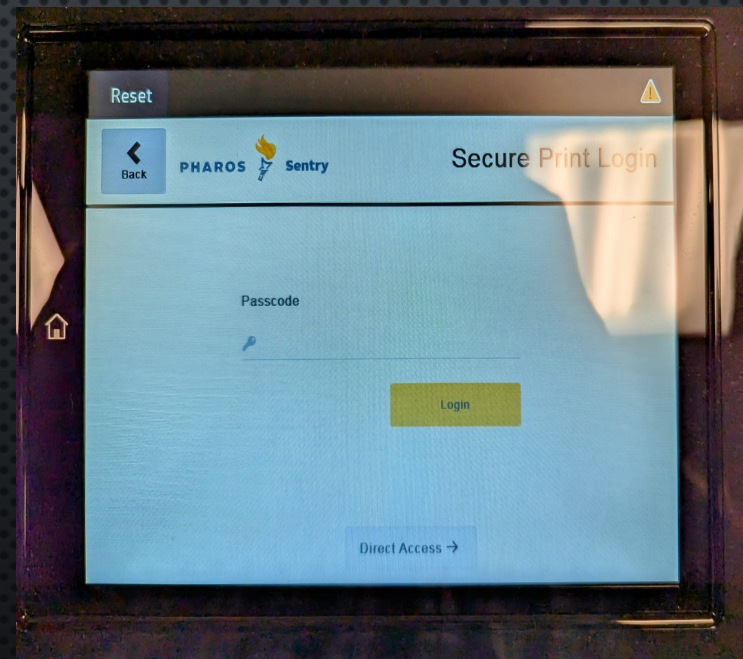
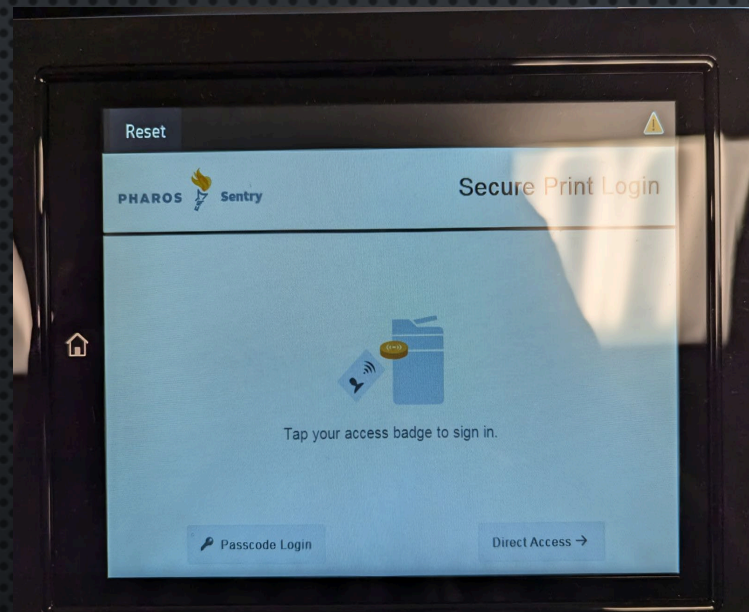

PHAROS SECURE RELEASE SETUP GUIDE

The Secure Release Test Page will print out

You MUST print the test page to complete the registration process

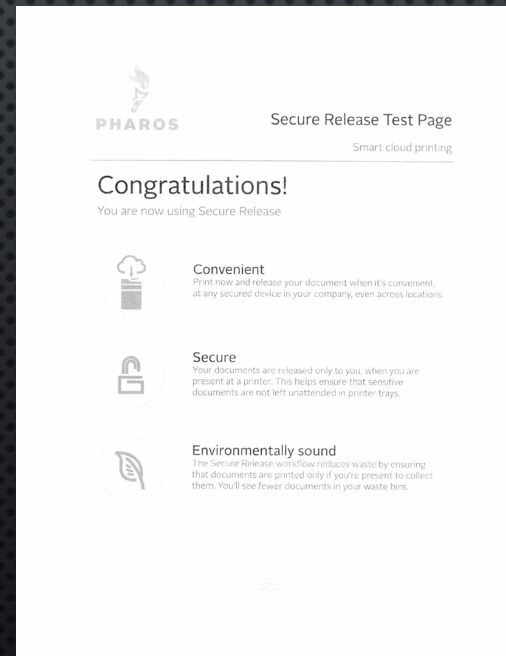

OPEN THE PHAROS SECURE RELEASE SETUP GUIDE

- Select “Proximity Card”

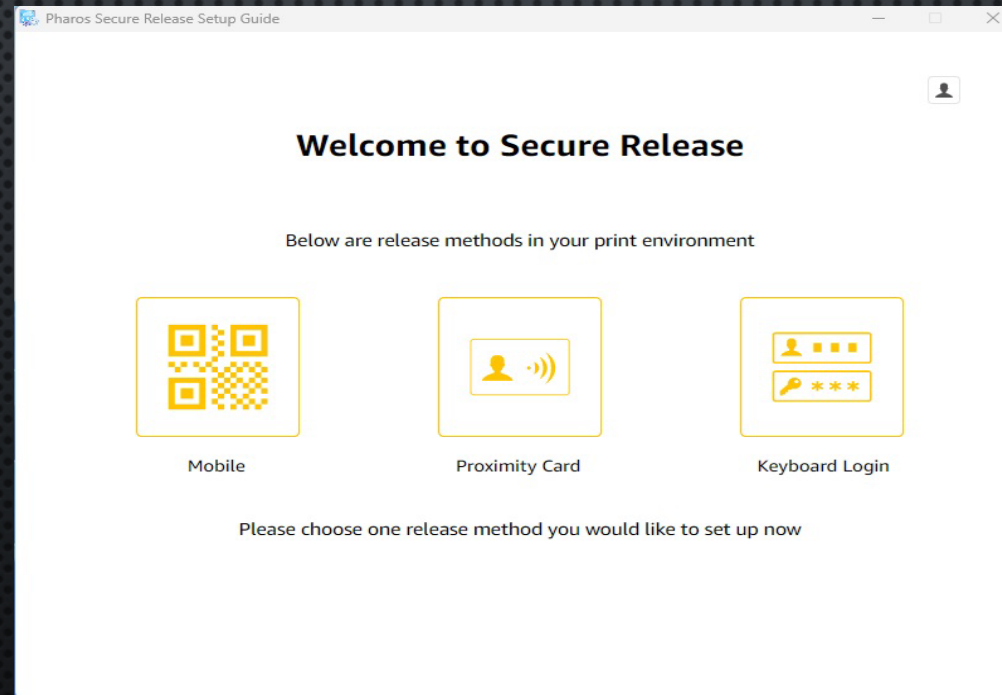

PHAROS SECURE RELEASE SETUP GUIDE

- Click “Start”

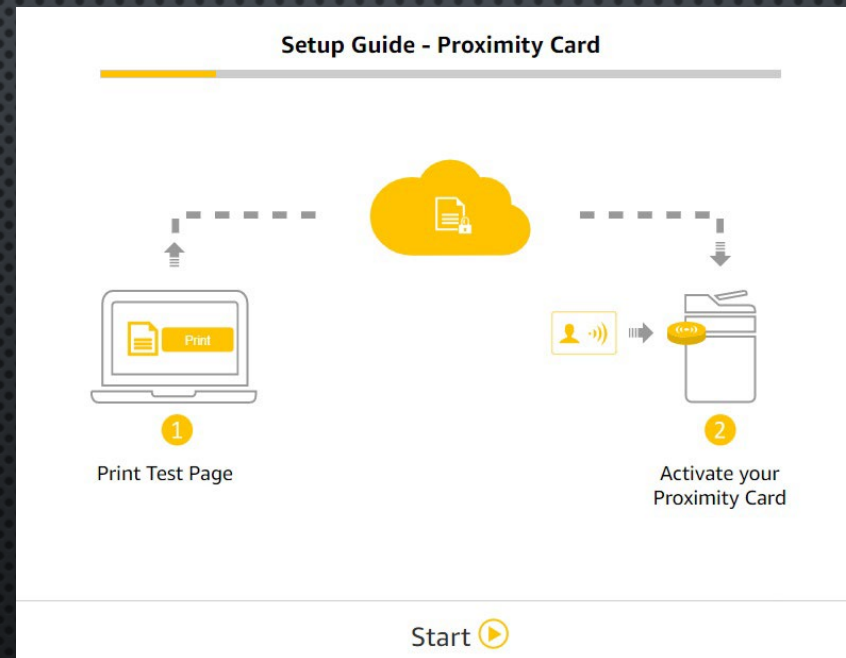

PHAROS SECURE RELEASE SETUP GUIDE

- Make certain the “Make Pharos Secure Printer your default printer” box is checked
- Click “Print test page”

Print Test Page

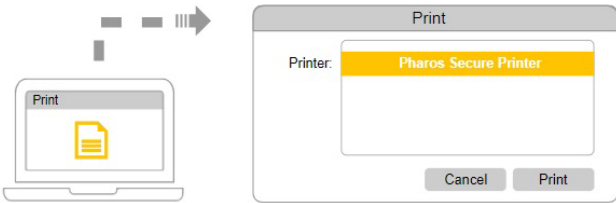

Print a test page and then select the 'Pharos Secure Printer'

Make Pharos Secure Printer your default printer

[Back](#) Print test page 

PHAROS SECURE RELEASE SETUP GUIDE

- Make certain “Pharos Secure Printer” is selected
- Click “Print” – This print window will then close

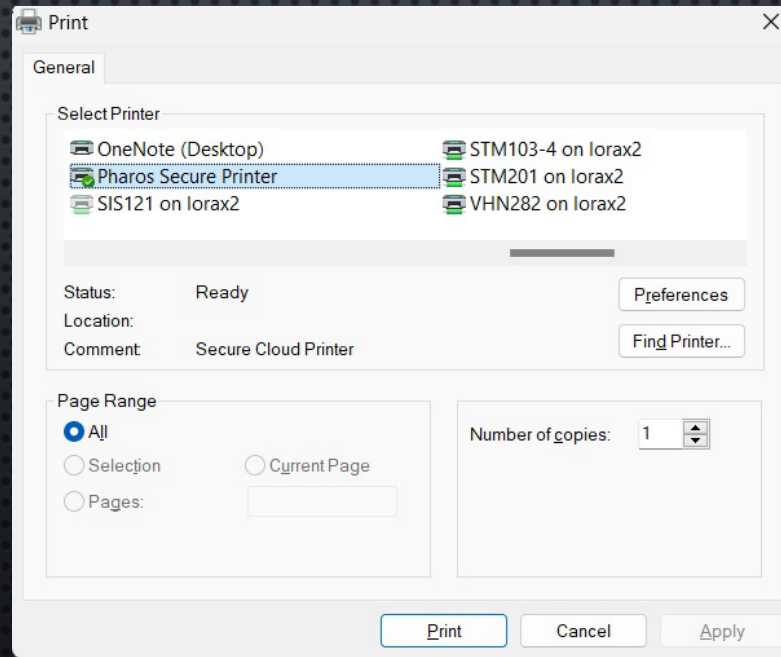

PHAROS SECURE RELEASE SETUP GUIDE

- Click “Next”

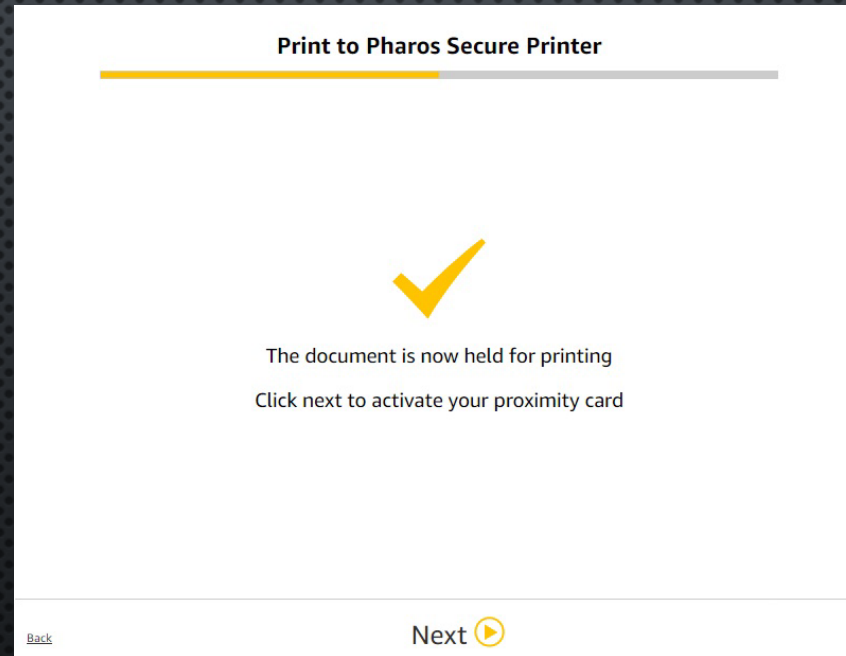

PHAROS SECURE RELEASE SETUP GUIDE

- Click “Next”

Activate your Proximity Card

Swipe your card at any secure printer. Instructions will be shown on screen or on a printed page. Once activated, you are ready to print jobs securely.



Follow the instructions on the printer's screen or printout

[Back](#) **Next** 

PHAROS SECURE RELEASE SETUP GUIDE

- Click “Finish”
- Go to the nearest printer with your ID Card with RFID sticker AND the passcode you activated earlier

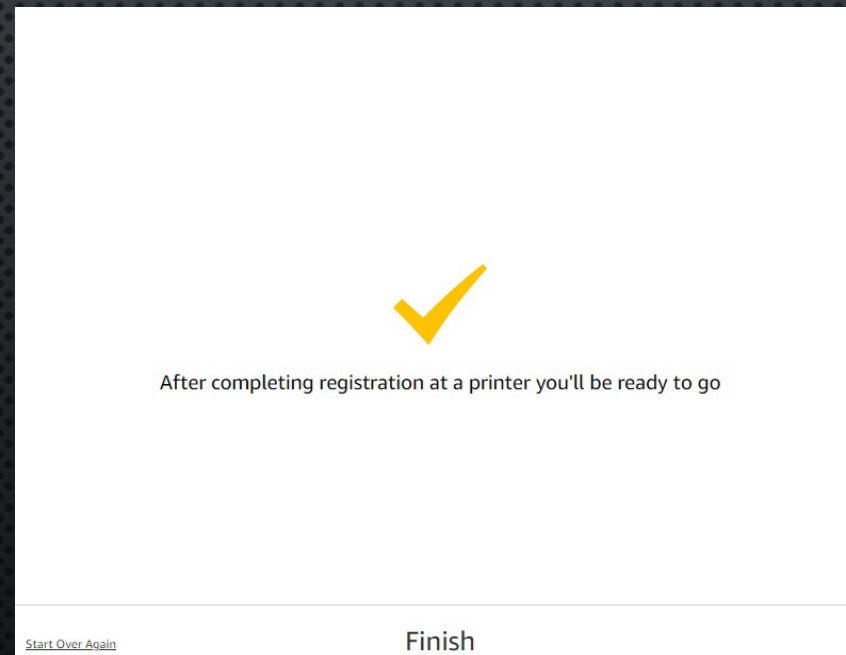

PHAROS SECURE RELEASE SETUP GUIDE

At the printer is the RFID Reader:

- Tap your ID Card with the RFID sticker on the reader
 - You will hear a beep and the light will change green momentarily before going back to red

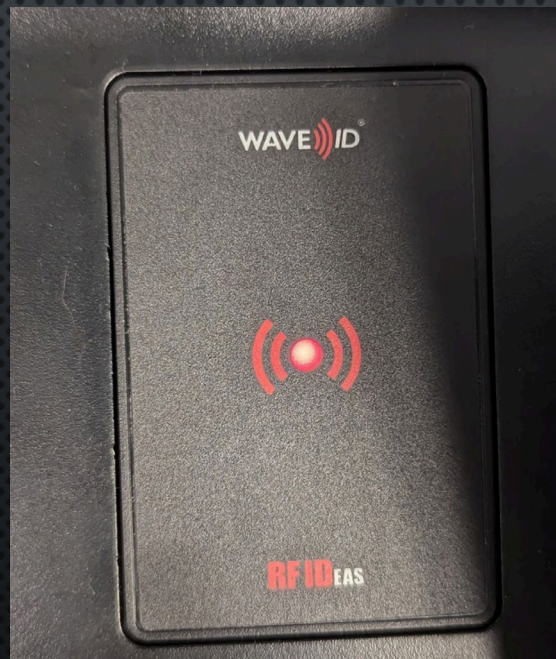

PHAROS SECURE RELEASE SETUP GUIDE

(Wake up the printer by touching the screen or the “Home” icon on the left of the screen)

The printer’s touchscreen will open to what you see in the picture on the left:

- Tap the line and a virtual keyboard will open to type in the passcode you were given and tap “Register” at the bottom of the screen.
- The print window will open showing the document in the queue, tap “Print All”

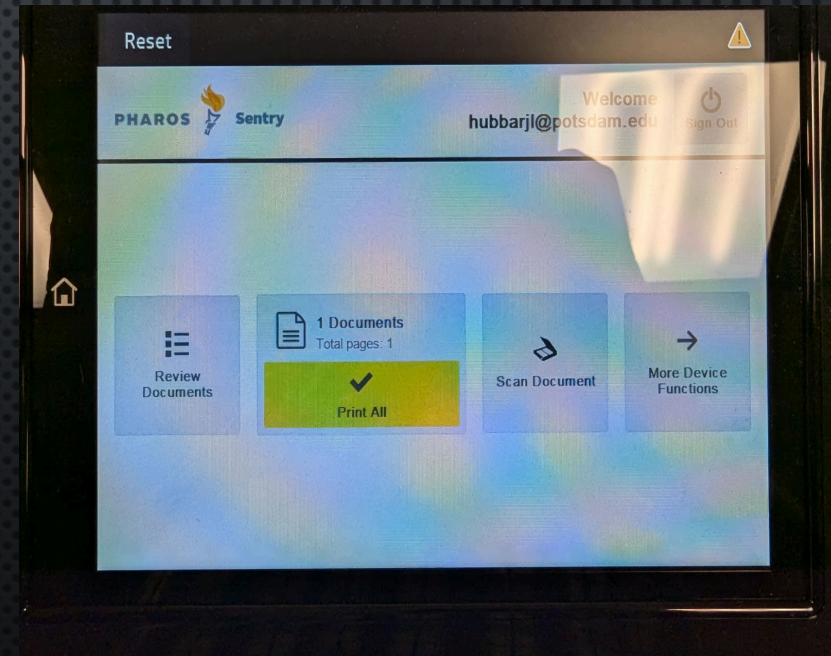
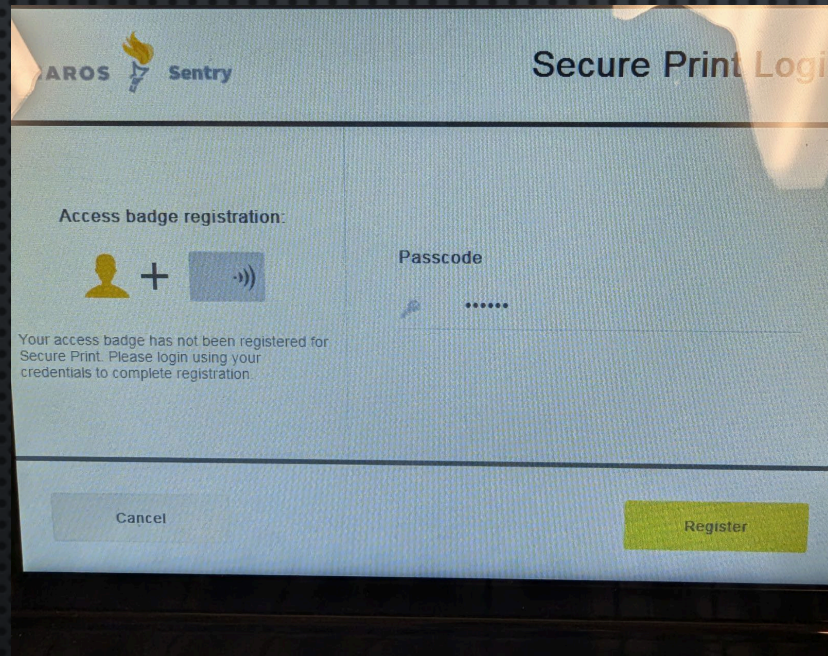

PHAROS SECURE RELEASE SETUP GUIDE

The Secure Release Test Page will print out

You MUST print the test page to complete the registration process

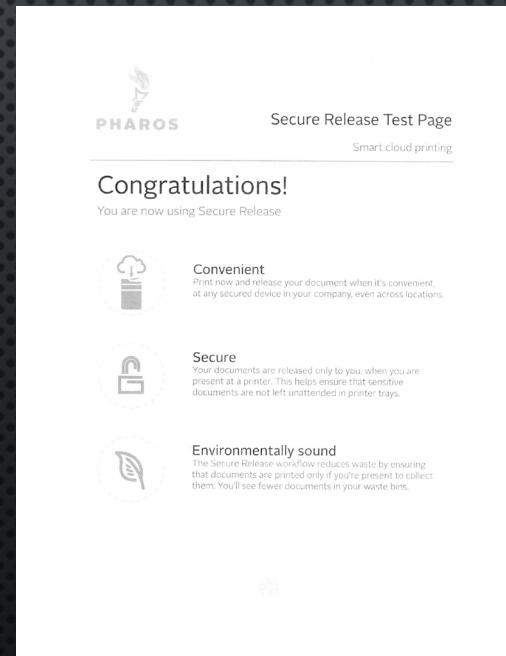

PRINTERS

Color and Black and White printers have multiple functions:

- Printing
- Copying
- Scanning (Scan to e-mail or OneDrive)



**SETTING UP YOUR MOBILE
DEVICE TO ACCESS YOUR
PHAROS SECURE PRINTING
ACCOUNT**

**OPEN THE
PHAROS SECURE RELEASE SETUP GUIDE**

BE PREPARED

- HAVE YOUR SUNY POTSDAM ID WITH THE RFID STICKER APPLIED
- YOUR PHONE WITH THE MOBILE APP INSTALLED

THE MOBILE APP CAN BE DOWNLOADED FROM THE APPLE APP STORE AND THE GOOGLE PLAY STORE AND IS CALLED

“PHAROS SECURE RELEASE”; THE ICON IS A GRAY CIRCLE WITH A TORCH.

(WARNING- DO NOT CHOOSE THE APP CALLED “PHAROS PRINT”!)

OPEN THE PHAROS SECURE RELEASE SETUP GUIDE

- Select “Mobile”

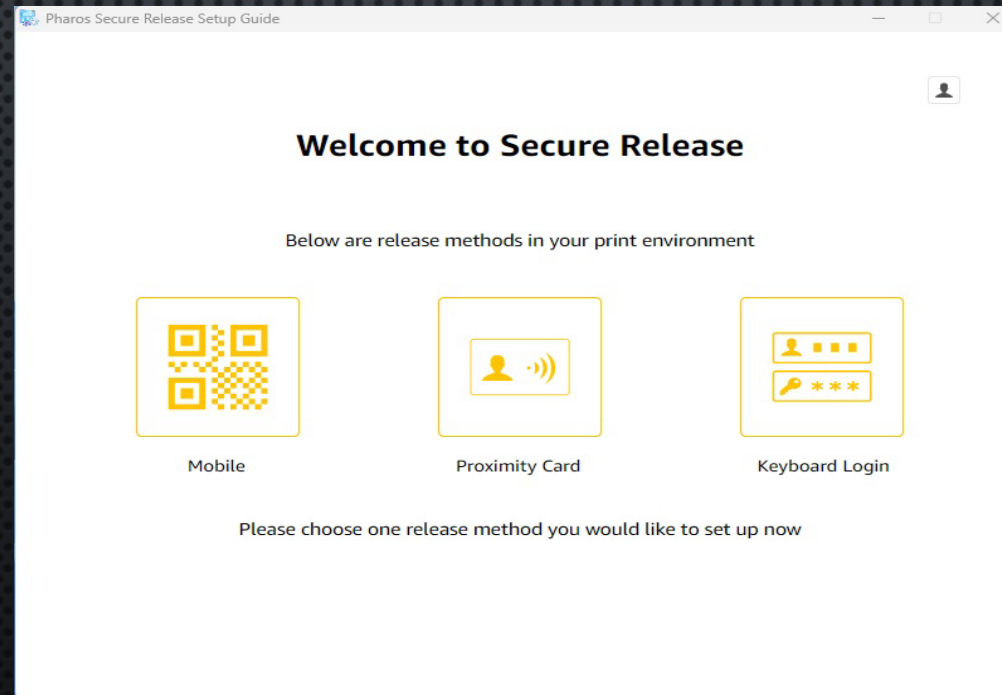

PHAROS SECURE RELEASE SETUP GUIDE

- Click “Start”

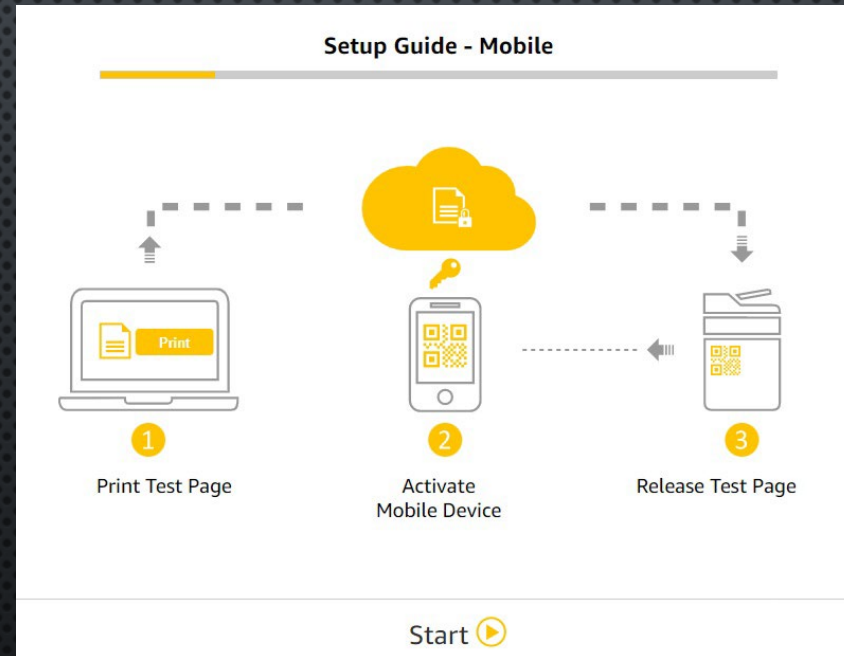

PHAROS SECURE RELEASE SETUP GUIDE

- Make certain the “Make Pharos Secure Printer your default printer” box is checked
- Click “Print test page”

Print Test Page

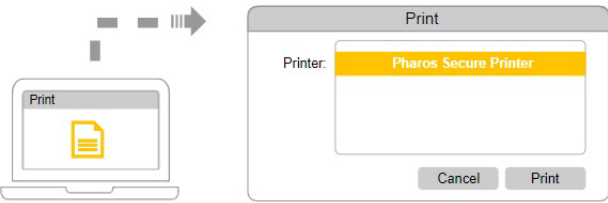

Print a test page and then select the 'Pharos Secure Printer'

Make Pharos Secure Printer your default printer

[Back](#) Print test page 

PHAROS SECURE RELEASE SETUP GUIDE

- Make Certain “Pharos Secure Printer” is selected.
- Click “Print” – This print window will then close.

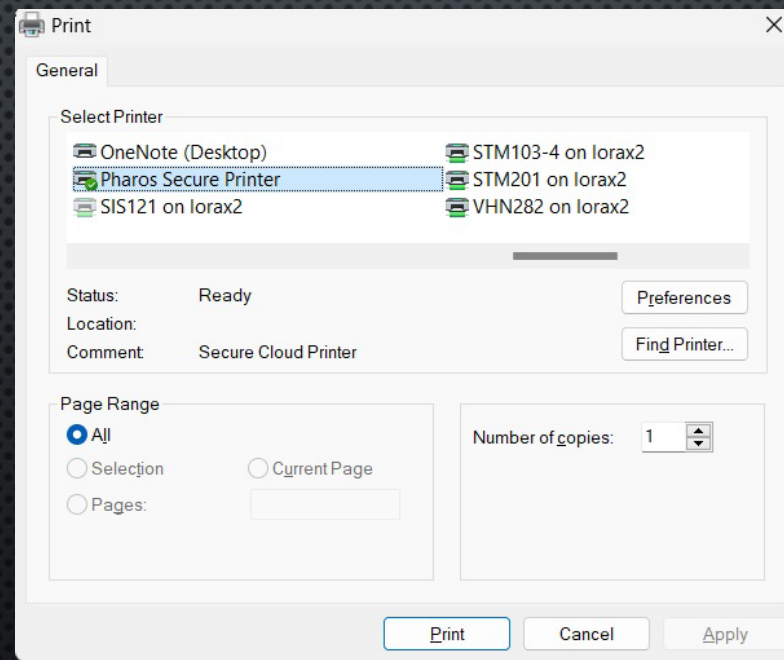

PHAROS SECURE RELEASE SETUP GUIDE

- Click “Next”

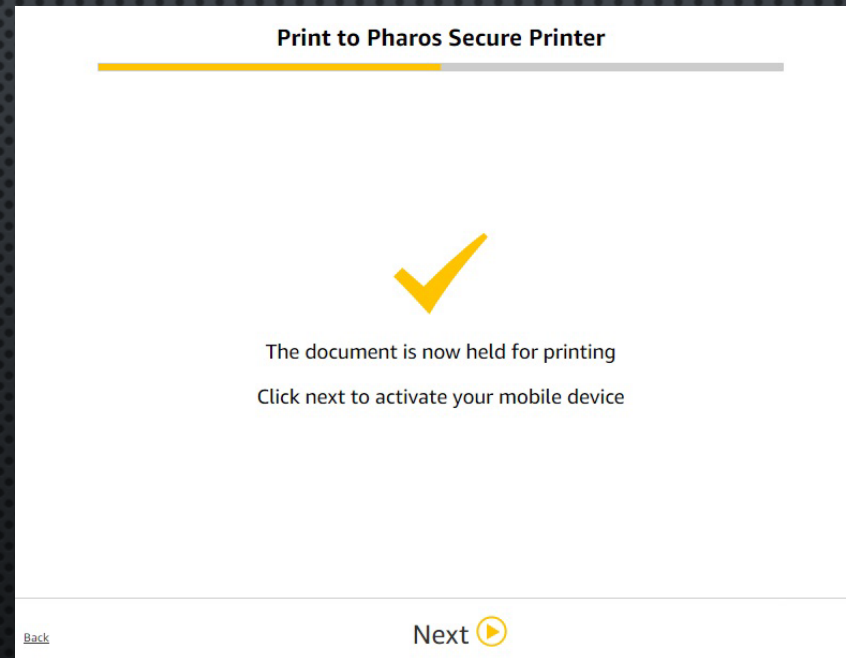

PHAROS SECURE RELEASE SETUP GUIDE

- Open the “Pharos Secure Release” app on your device
- Click the “Scan” button on the app
- Scan the QR code that appears on your computer screen like the one in the screenshot shown here.
- Click Next

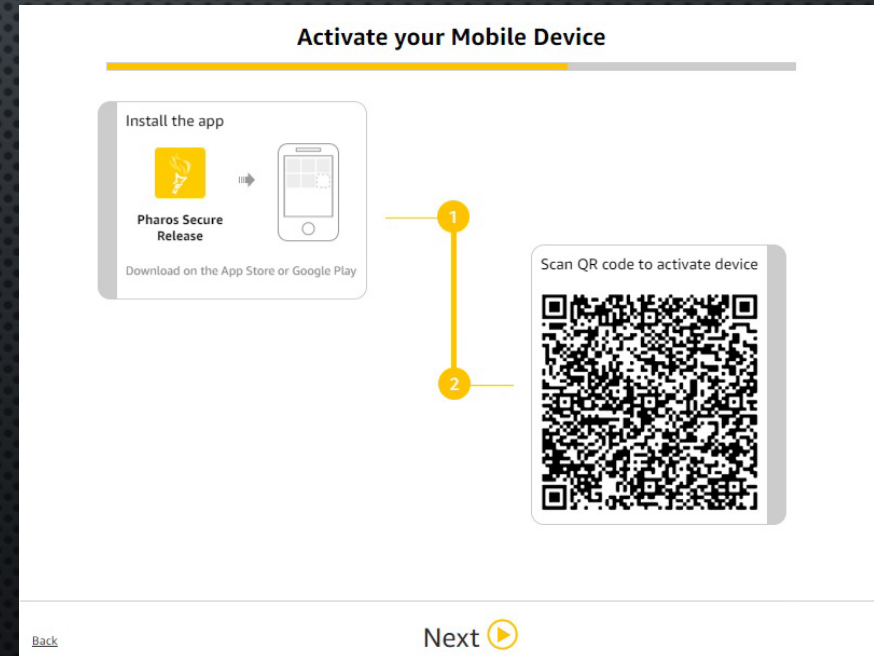

PHAROS SECURE RELEASE SETUP GUIDE

- The “Pharos Secure Release” window shown here will open on your computer

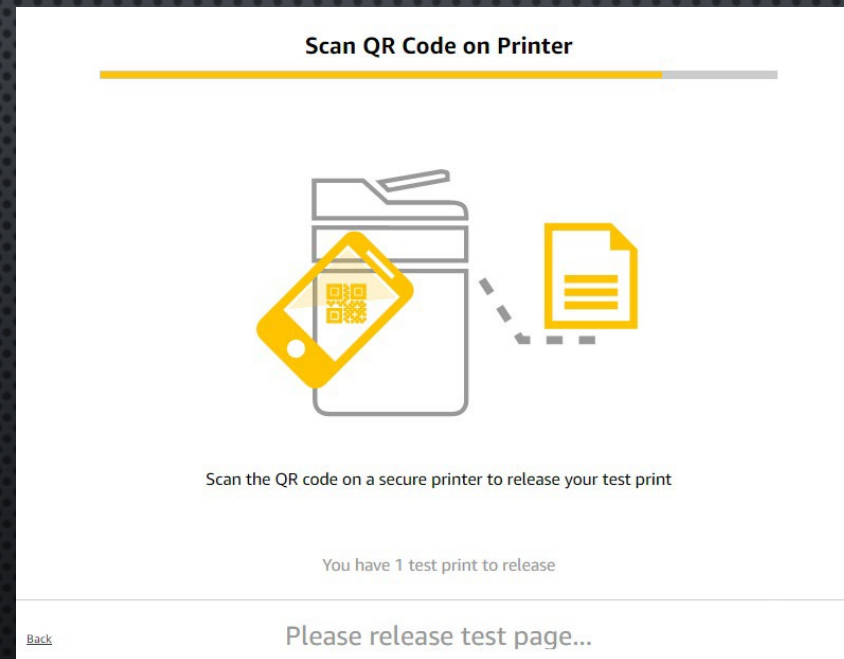

PHAROS SECURE RELEASE SETUP GUIDE

- The “Pharos Secure Release” app screen will display the print queue screen showing you have a document waiting.
- Go to the nearest printer (*Wake up the printer by touching the screen or the “Home” icon on the left of the screen*)
- Click “Print all” or Click “Review Print Jobs” and select the test page
- A scan window will open on your device for you to scan the QR code on the front of the printer

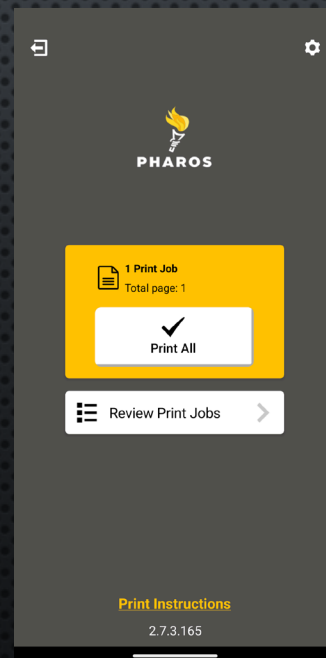

PHAROS SECURE RELEASE SETUP GUIDE

The Secure Release Test Page will print out

You MUST print the test page to complete the registration process

