



Ambient Environmental, Inc.
Comprehensive Building Science Solutions

June 19, 2015

Mr. Larry Leashomb
SUNY Potsdam
44 Pierrpont Ave
Potsdam, New York 13676

RE: Asbestos Bulk Sampling Services
Barrington Student Union
44 Pierrepont Ave
Potsdam, New York 13676
Ambient Project Number: 150518AA

Dear Mr. Leashomb:

Ambient Environmental Inc. (Ambient) was pleased to provide asbestos bulk sampling for a client targeted area in Barrington Student Union. Matthew Weeks of Ambient conducted the sampling on May 20, 2015. The samples were sent to AmeriSci of New York, NY for analysis. The results were sent to you via email.

A total of fourteen bulk samples were collected from the Raised Kitchen Area (131) of Barrington Student Union and analyzed for asbestos content. The laboratory results and chain of custody documentation are attached to this letter, along with our personnel and laboratory certifications. Ambient has also provided a comprehensive summary table of all sampling events performed by our company, along with the corresponding results and drawings.

RESULTS

The materials collected and analyzed from Barrington Student Union Raised Kitchen Area (131) on this date are negative for asbestos.

If you have any questions or need additional information, please contact us at (518) 482-0704.

Sincerely,
Ambient Environmental, Inc.



Joella Viscusi
President

Enclosure

SUNY POTSDAM
BARRINGTON STUDENT UNION
SUMMARY OF ASBESTOS SAMPLES AND ANALYSIS RESULTS

Sample Number	Type of Sample	Location of Sample	Asbestos Content
Ambient Sampling Event January 25, 2011			
Ambient Project# 101214AB			
003-01	Mudded Fitting	Kitchen 2 nd Floor	NAD
003-02	Mudded Fitting	Kitchen 2 nd Floor	NAD
003-03	Mudded Fitting Debris	Kitchen 2 nd Floor	NAD
Ambient Sampling Event April 13, 2011			
Ambient Project# 110325AB			
01-01	Glazing	Exterior Door	Trace Chrysotile
01-02	Glazing	Exterior Door	Trace Chrysotile
02-01	Caulking	Exterior Door	1.6% Tremolite 0.4% Chrysotile
02-02	Caulking	Exterior Door	NA/PS
Ambient Sampling Event June 3, 2011			
Ambient Project# 110601AA			
004-01	Vapor Barrier	Main Bldg. Vestibule – Center	NAD
004-02	Vapor Barrier	Main Bldg. Vestibule – Center	NAD
Ambient Sampling Event June 16, 2011			
Ambient Project# 110601AA			
006-01	Red Interior Window Caulk	2 nd Floor Main Vestibule	NAD
006-02	Red Interior Window Caulk	2 nd Floor Main Vestibule	NAD
007-01	Red Exterior Window Caulk	2 nd Floor Main Vestibule	NAD
007-02	Red Exterior Window Caulk	2 nd Floor Main Vestibule	NAD
008-01	Concrete Ceiling	2 nd Floor Exterior Overhang	NAD
008-02	Concrete Ceiling	2 nd Floor Exterior Overhang	NAD
008-03	Concrete Ceiling	2 nd Floor Exterior Overhang	NAD
008-04	Concrete Ceiling	2 nd Floor Exterior Overhang	NAD
008-05	Concrete Ceiling	2 nd Floor Exterior Overhang	NAD
008-06	Concrete Ceiling	2 nd Floor Exterior Overhang	NAD
008-07	Concrete Ceiling	2 nd Floor Exterior Overhang	NAD
009-01	Plaster Coat	Exterior Overhang	NAD
009-02	Plaster Coat	Exterior Overhang	NAD
009-03	Plaster Coat	Exterior Overhang	NAD
009-04	Plaster Coat	Exterior Overhang	NAD
009-05	Plaster Coat	Exterior Overhang	NAD
009-06	Plaster Coat	Exterior Overhang	NAD

SUNY POTSDAM
BARRINGTON STUDENT UNION
SUMMARY OF ASBESTOS SAMPLES AND ANALYSIS RESULTS

Sample Number	Type of Sample	Location of Sample	Asbestos Content
009-07	Plaster Coat	Exterior Overhang	NAD
Ambient Sampling Event July 21, 2011 Ambient Project# 110718AA			
01-01	Spray-On	East Entryway	NAD
01-02	Spray-On	North Entryway	NAD
01-03	Spray-On	West Entryway	NAD
Ambient Sampling Event December 6, 2011 Ambient Project# 111202AA			
Bathrooms			
010-01	2x2 Ceramic Floor Tile	Room 121 Hall	NAD
010-02	2x2 Ceramic Floor Tile	Room 120 Hall	NAD
011-01	2x2 Ceramic Floor Tile Grout	Room 121 Hall	NAD
011-02	2x2 Ceramic Floor Tile Grout	Room 120 Hall	NAD
012-01	Brown Popcorn Ceiling	Room 120 Hall	NAD
012-02	Brown Popcorn Ceiling	Room 207 Hall	NAD
012-03	Brown Popcorn Ceiling	Room 121 Hall	NAD
013-01	Brown 1x1 Ceramic Floor Tile	Room 122A Women	NAD
013-02	Brown 1x1 Ceramic Floor Tile	Room 123A Men	NAD
014-01	Brown 1x1 Floor Tile Grout	Room 122 Women	NAD
014-02	Brown 1x1 Floor Tile Grout	Room 123A Men	NAD
015-01	12x12 Terracotta Floor Tile	Room 207 Hall	NAD
015-02	12x12 Terracotta Floor Tile	Room 206 Hall	NAD
016-01	Yellow Floor Tile Mastic	Room 207 Hall	NAD
016-02	Yellow Floor Tile Mastic	Room 206 Hall	NAD
017-01	Yellow Carpet Mastic	Room 207 Hall	NAD
017-02	Yellow Carpet Mastic	Room 207 Hall	NAD
018-01	Black 6" Cove Base	Room 206 Hall	NAD
018-02	Black 6" Cove Base	Room 207 Hall	NAD
019-01	Yellow Cove Base Mastic	Room 206 Hall	NAD
019-02	Yellow Cove Base Mastic	Room 207 Hall	NAD
020-01	White 3x3 Ceramic Wall Tile	Room 125 Women	NAD
020-02	White 3x3 Ceramic Wall Tile	Room 231 Women	NAD
021-01	White 3x3 Ceramic Wall Tile Grout	Room 125 Women	NAD

SUNY POTSDAM
BARRINGTON STUDENT UNION
SUMMARY OF ASBESTOS SAMPLES AND ANALYSIS RESULTS

Sample Number	Type of Sample	Location of Sample	Asbestos Content
021-02	White 3x3 Ceramic Wall Tile Grout	Room 231 Women	NAD
022-01	Plaster Wall Skim	Room 226 Women	NAD
022-02	Plaster Wall Skim	Room 207 Hall	NAD
022-03	Plaster Wall Skim	Room 121 Hall	NAD
022-04	Plaster Wall Skim	Room 125 Women	NAD
022-05	Plaster Wall Skim	Room 123 Men	NA
022-06	Plaster Wall Skim	Room 123 Men	NAD
023-01	Plaster Wall Base	Room 226 Women	NAD
023-02	Plaster Wall Base	Room 207 Hall	NAD
023-03	Plaster Wall Base	Room 121 Hall	NAD
023-04	Plaster Wall Base	Room 125 Women	NAD
023-05	Plaster Wall Base	Room 123 Men	NAD
024-01	Sheetrock	Room 120 Hall	NAD
024-02	Sheetrock	Room 120 Hall	NAD
025-01	Vinyl Wall Paper	Room 207 Hall	NAD
025-02	Vinyl Wall Paper	Room 121 Hall	NAD
026-01	Plaster Ceiling Skim	Room 231 Women	NAD
026-02	Plaster Ceiling Skim	Room 124 Men	NAD
026-03	Plaster Ceiling Skim	Room 123 Men	NAD
027-01	Plaster Ceiling Base	Room 231 Women	NAD
027-02	Plaster Ceiling Base	Room 124 Men	NAD
027-03	Plaster Ceiling Base	Room 123 Men	NAD
028-01	White Caulk	Room 231 Women Vanity	NAD
028-02	White Caulk	Room 226 Women Vanity	NAD
Ambient Sampling Event March 1, 2012 Ambient Project# 120229AB			
001-01	2x4 Drop Ceiling Tile – White w/ moderate horizontal fissures	Room 219	NAD
001-02	2x4 Drop Ceiling Tile – White w/ moderate horizontal fissures	Hall Adjacent to Mailroom	NAD
002-01	2x4 Drop Ceiling Tile – White w/ large and deep horizontal fissures	College Store – Storage	NAD

SUNY POTSDAM
BARRINGTON STUDENT UNION
SUMMARY OF ASBESTOS SAMPLES AND ANALYSIS RESULTS

Sample Number	Type of Sample	Location of Sample	Asbestos Content
002-02	2x4 Drop Ceiling Tile – White w/ large and deep horizontal fissures	College Store – Storage	NAD
003-01	1x1 Splined Ceiling Tile ⁽²⁾	Room 215	NAD
003-02	1x1 Splined Ceiling Tile ⁽²⁾	Room 212	NAD
Ambient Sampling Event May 23, 2012 Ambient Project# 1200515AC			
029-01	Fitting Insulation	Large Diameter in Wet Wall	7.8% Chrysotile
029-02	Fitting Insulation	Large Diameter in Wet Wall	NA/PS
030-01	Fitting Insulation	1" Diameter in Wet Wall	8.7% Chrysotile
030-02	Fitting Insulation	1" Diameter in Wet Wall	NA/PS
030-03	Fitting Insulation	1" Diameter Debris in Wet Wall	NA/PS
031-01	Fitting Insulation	Above Ceiling @ Panel Access	NAD
031-02	Fitting Insulation	Above Ceiling @ Panel Access	NAD
Ambient Sampling Event July 10, 2012 Ambient Project# 120709AB			
001-01	Ceiling Base	Exterior Overhang – Front Entrance	NAD
001-02	Ceiling Base	Exterior Overhang – Front Entrance	NAD
001-03	Ceiling Base	Exterior Overhang – Front Entrance	NAD
002-01	Ceiling Finish	Exterior Overhang – Front Entrance	NAD
002-02	Ceiling Finish	Exterior Overhang – Front Entrance	NAD
002-03	Ceiling Finish	Exterior Overhang – Front Entrance	NAD
003-01	Caulk	Inside/Outside Front Entrance Overhang	NAD
003-02	Caulk	Inside/Outside Front Entrance Overhang	NAD
Ambient Sampling Event December 20, 2012 Ambient Project# 121221AG			
001-01	12x12 Orange VFT	2 nd Floor Bathroom	NAD
001-02	12x12 Orange VFT	2 nd Floor Bathroom	NAD
002-01	12x12 Mastic	2 nd Floor Bathroom	NAD
002-02	12x12 Mastic	2 nd Floor Bathroom	NAD

SUNY POTSDAM
BARRINGTON STUDENT UNION
SUMMARY OF ASBESTOS SAMPLES AND ANALYSIS RESULTS

Sample Number	Type of Sample	Location of Sample	Asbestos Content
003-01	Debris on Floor	3 rd Floor Mechanical Room	NAD
003-02	Debris on Floor *	3 rd Floor Mechanical Room	30.8% Chrysotile
003-03	Debris on Floor *	3 rd Floor Mechanical Room	NA/PS
Ambient Sampling Event February 26, 2013 Ambient Project #: 130222AA			
032-01	Debris- Mud Joint Packing	3 rd Floor Mechanical Room	NAD
032-02	Debris- Mud Joint Packing	3 rd Floor Mechanical Room	NAD
Ambient Sampling Event March 7, 2013 Ambient Project #: 130307AA			
001-01	Cementious Debris	Kitchen Ramp	NAD
001-02	Cementious Board	Kitchen Ramp Door	NAD
001-03	Cementious Board	Kitchen Ramp Door	NAD
002-01	Sheetrock	2 nd Floor MPR	NAD
002-02	Sheetrock	2 nd Floor MPR	NAD
003-01	Joint Compound	2 nd Floor MPR	NAD
003-02	Joint Compound	2 nd Floor MPR	NAD
Ambient Sampling Event March 21, 2013 Ambient Project #: 130320AA- BASEMENT			
01-01	Insulation	Steam Line-Basement	12.5% Amosite Trace Chrysotile
01-02	Insulation	Steam Line-Basement	NA/PS
01-03	Insulation	Steam Line-Basement	NA/PS
02-01	Mudded Fitting	Non Leaking Pipe-Basement	NAD
02-02	Mudded Fitting	Non Leaking Pipe-Basement	NAD
02-03	Mudded Fitting	Non Leaking Pipe-Basement	NAD
03-01	Mudded Fitting	Leaking Pipe-Basement	NAD
03-02	Mudded Fitting	Leaking Pipe-Basement	NAD
03-03	Mudded Fitting	Leaking Pipe-Basement	NAD
04-01	Mudded Fitting	Chilled Water Supply Elbow	NAD
04-02	Mudded Fitting	Chilled Water Supply Elbow	NAD
04-03	Mudded Fitting	Chilled Water Supply Elbow	NAD
05-01	Mudded Fitting	Chilled Water Return Elbow	NAD
05-02	Mudded Fitting	Chilled Water Return Elbow	NAD
05-03	Mudded Fitting	Chilled Water Return Elbow	NAD
06-01	Mudded Fitting	Sewer Drain Cleanout	1.3% Amosite

SUNY POTSDAM
BARRINGTON STUDENT UNION
SUMMARY OF ASBESTOS SAMPLES AND ANALYSIS RESULTS

Sample Number	Type of Sample	Location of Sample	Asbestos Content
06-02	Mudded Fitting	Sewer Drain Cleanout	NA/PS
06-03	Mudded Fitting	Sewer Drain Cleanout	NA/PS
07-01	Debris # 2 *	Debris pile #2	25.0% Amosite
07-02	Debris # 2 *	Debris pile #2	NA/PS
08-01	Debris #3 *	Debris pile #3	NAD
08-02	Debris #3 *	Debris pile #3	NAD
09-01	Debris #1 *	Debris pile #1	30.8% Amosite
09-02	Debris #1 *	Debris pile #1	NA/PS
Ambient Sampling Event March 26, 2013 Ambient Project #: 130320AA			
01-01	Fire Doors	East Entry to Post Office	30.8% Amosite
01-02	Fire Doors	East Entry to Post Office	26.7% Amosite
01-03	Fire Doors	2 nd Floor Kitchen Doors	30.8% Amosite
01-04	Fire Doors	2 nd Floor Kitchen Doors	23.5% Amosite
01-05	Fire Doors	2 nd Floor Center Hallway	17.4% Amosite
01-06	Fire Doors	2 nd Floor Center Hallway	17.4% Amosite
02-07	Blue Grey Floor Tile	1 st Floor Dining Area	NAD
02-08	Blue Grey Floor Tile	1 st Floor Dining Area	NAD
02-09	Green Floor Tile	1 st Floor Dining Area	NAD
02-10	Green Floor Tile	1 st Floor Dining Area	NAD
02-11	Green and Red Floor Tile	1 st Floor Dining Area	NAD
02-12	Green and Red Floor Tile	1 st Floor Dining Area	NAD
02-13	Black Floor Tile	1 st Floor Dining Area	NAD
02-14	Black Floor Tile	1 st Floor Dining Area	NAD
03-15	Cove Base	1 st Floor Dining Area	NAD
03-16	Cove Base	1 st Floor Dining Area	NAD
03-17	Tile Adhesive	1 st Floor Dining Area	NAD
03-18	Tile Adhesive	1 st Floor Dining Area	NAD
Ambient Sampling Event April 18, 2013 Ambient Project #: 130419AC			
01-01	Skimcoat - Wall	Center Hallway of Petes Place-2 nd Floor	NAD
01-02	Skimcoat - Wall	Center Hallway of Petes Place-2 nd Floor	NAD
01-03	Skimcoat - Wall	Center Hallway of Petes Place-2 nd Floor	NAD

SUNY POTSDAM
BARRINGTON STUDENT UNION
SUMMARY OF ASBESTOS SAMPLES AND ANALYSIS RESULTS

Sample Number	Type of Sample	Location of Sample	Asbestos Content
01-04	Skimcoat - Wall	Center Hallway of Petes Place-2 nd Floor	NAD
01-05	Skimcoat - Wall	Center Hallway of Petes Place-2 nd Floor	NAD
02-06	Plaster-Wall (Finish Coat)	Center Hallway of Petes Place-2 nd Floor	NAD
02-07	Plaster-Wall (Finish Coat)	Center Hallway of Petes Place-2 nd Floor	NAD
02-08	Plaster-Wall (Finish Coat)	Center Hallway of Petes Place-2 nd Floor	NAD
02-09	Plaster-Wall (Finish Coat)	Center Hallway of Petes Place-2 nd Floor	NAD
02-10	Plaster-Wall (Finish Coat)	Center Hallway of Petes Place-2 nd Floor	NAD
03-11	Wall Protector	Center Hallway of Petes Place-2 nd Floor	NAD
03-12	Wall Protector	Center Hallway of Petes Place-2 nd Floor	NAD
04-13	Floor - Tan Tile 12x12	East Lobby	NAD
04-14	Floor - Tan Tile 12x12	West Lobby	NAD
05-15	Floor - White Tile 12x12	East Lobby	NAD
05-16	Floor - White Tile 12x12	East Lobby	NAD
06-17	Floor - Grey Tile 12x12	West Lobby	NAD
06-18	Floor - Grey Tile 12x12	West Lobby	NAD
07-19	Floor Tile Adhesive (all colors)	East Lobby	NAD
07-20	Floor Tile Adhesive (all colors)	West Lobby	NAD
08-21	Cove Base	East Lobby	NAD
08-22	Cove Base	West Lobby	NAD
09-23	Cove Base Glue	East Lobby	NAD
09-24	Cove Base Glue	West Lobby	NAD
Ambient Sampling Event May 21, 2013 Ambient Project #: 130520AA Dining Hall⁽¹⁾			
Sample Number	Type of Sample	Location of Sample	Asbestos Content
01-01	Green Floor Tile	Outside West Entrance	NAD

SUNY POTSDAM
BARRINGTON STUDENT UNION
SUMMARY OF ASBESTOS SAMPLES AND ANALYSIS RESULTS

Sample Number	Type of Sample	Location of Sample	Asbestos Content
02-02	Red Floor Tile	4' West of Counter	NAD
03-04	White 9x9 Floor Tile	4' from North below Stage	NAD
03-03	White 9x9 Floor Tile	Center, below Stage	NAD
04-05	Yellow (9x9) Tile Adhesive	West end of Stage	NAD
04-06	Yellow (9x9) Tile Adhesive	6' from West end of Stage	NAD
05-07	Debris	West side of counter	NAD
05-08	Debris	West side of counter	NAD
Ambient Sampling Event May 29, 2013 Ambient Project #: 130520AA Basement Area 2			
B501-01	Mudded Fitting	Roof Drain	0.97% Amosite
B501-02	Mudded Fitting	Roof Drain	0.95% Amosite
B501-03	Mudded Fitting	Roof Drain	0.98% Amosite
B502-04	Mudded Fitting	Condensation Line	NAD
Ambient Sampling Event: January 6, 2014 Ambient Project # 140107AA Basement Mechanical			
0101-01	Mudded Fitting	Small Valve Mechanical Line 1	NAD
Ambient Sampling Event: January 15, 2014 2nd Floor Hall			
0102-01	12x12 Crag Ceiling Tile ⁽²⁾	2 nd Floor Hall, by Room 217	NAD
0102-02	12x12 Crag Ceiling Tile ⁽²⁾	2 nd Floor Hall, by Room 217	NAD
Ambient Sampling Event March 6, 2014 Ambient Project # 140307AA			
02D-01	Debris	Entry Hall, Above Ceiling	NAD
02D-02	Debris	Storage By Entry Hall	NAD
02D-03	Debris	Storage By Entry Hall	NAD
02DE-04	Debris(Elbow)	Storage By Sales Floor	6.7% Chrysotile
02DE-05	Debris(Elbow)	Storage By Sales Floor	NA/PS
0201-06	Mudded Elbow	Above Dairy	NAD
0201-07	Mudded Elbow	Above Novelty Food	NAD
0201-08	Mudded Elbow	Above Entry Lighting	NAD
0202-09	12x12 Beige Floor Tile	Store Back Entry	1.6% Chrysotile
0202-10	12x12 Beige Floor Tile	Store Back Entry	NA/PS
0203-11	12x12 Black Mastic	Store Back Entry	NAD
0203-12	12x12 Black Mastic	Store Back Entry	NAD

SUNY POTSDAM
BARRINGTON STUDENT UNION
SUMMARY OF ASBESTOS SAMPLES AND ANALYSIS RESULTS

0204-13	12x12 Light Gray Floor Tile	Store Back Entry	NAD
Sample Number	Type of Sample	Location of Sample	Asbestos Content
0204-14	12x12 Light Gray Floor Tile	Store Back Entry	NAD
Ambient Sampling Event: May 15, 2014 Ambient Project #140517AA Rooms 126, 127 & 130A			
051401-01	1x1 Gray Ceiling Tile ⁽²⁾	Room 127, North East	NAD
051401-02	1x1 Gray Ceiling Tile ⁽²⁾	Room 127, North East	NAD
051402-03	Debris	Room 127, North East	NAD
051402-04	Debris	Room 127, North East	NAD
051403-05	Mudded Fitting	Room 127, North East	NAD
051403-06	Mudded Fitting	Room 127, North East	NAD
051403-07	Mudded Fitting	Room 127, North East	NAD
051404-08	Duct Insulation	Room 130A, Center	NAD
051404-09	Duct Insulation	Room 130A, Center	NAD
051404-10	Duct Insulation	Room 130A, Center	NAD
051405-11	12x12 Dark Grey Floor Tile	Room 130A, At Door	NAD
051405-12	12x12 Dark Grey Floor Tile	Room 130A, Center	NAD
051406-13	12x12 Yellow Floor Tile	Room 130A, At Door	NAD
051406-14	12x12 Yellow Floor Tile	Room 130A, South End	NAD
051407-15	12x12 Black Floor Tile	Room 130A, North Side	NAD
051407-16	12x12 Black Floor Tile	Room 130A, North Side	NAD
051408-17	Black Floor Tile Mastic	Room 130A, North Side	NAD
051408-18	Black Floor Tile Mastic	Room 130A, North Side	NAD
051409-19	Fire Door Insulation	Room 130A, Door To Room 126A	33.3% Chrysotile
051409-20	Fire Door Insulation	Room 130A, Door To Room 126A	NA/PS
Ambient Sampling Event: May 22, 2014 Ambient Project #: 140522AC Exterior			
0514101-01	Brick	West Exterior , North End	NAD
0514101-02	Brick	West Exterior, By North	NAD
0514102-03	Brick Grout	West Exterior , North End	NAD

SUNY POTSDAM
BARRINGTON STUDENT UNION
SUMMARY OF ASBESTOS SAMPLES AND ANALYSIS RESULTS

0514102-04	Brick Grout	West Exterior, By North	NAD
Ambient Sampling Event: June 24, 2014 Ambient Project # 140613AD Cookies & Cream Rm 130A			
061410-01	Water Guard Under Tile	Room 130A, East Side	NAD
061410-02	Water Guard Under Tile	Room 130A, East Side	NAD
061411-03	Floor Leveler	Room 130A, West Side	NAD
061411-04	Floor Leveler	Room 130A, West Side	NAD
061412-05	Mudded Fitting	Room 130A, North West	26.7% Chrysotile
061412-06	Mudded Fitting	Room 130A, North West	NA/PS
061412-07	Mudded Fitting	Room 130A, North West	NA/PS
Ambient Sampling Event: November 10, 2014 Ambient Project # 1401110AA 2nd Floor Center Hallway			
111001-01	Wallpaper	2 nd Floor East Hallway	NAD
111001-02	Wallpaper	2 nd Floor East Hallway	NAD
111002-03	Cove Base 4" Cream	2 nd Floor East Hallway	NAD
111002-04	Cove Base 4" Cream	2 nd Floor East Hallway	NAD
111003-05	Cove Base Adhesive, Brown	2 nd Floor East Hallway	NAD
111003-06	Cove Base Adhesive, Brown	2 nd Floor East Hallway	NAD
Ambient Sampling Event May 20, 2015 Ambient Project #: 150518AA Raised Kitchen Area 131			
052015-01	Pink 12x12 Floor Tile	Top Layer Room 131 NE	NAD
052015-02	Pink 12x12 Floor Tile	Top Layer Room 131 E	NAD
052015-03	Pink Floor Tile Mastic	Top Layer Room 131 NE	NAD
052015-04	Pink Floor Tile Mastic	Top Layer Room 131 E	NAD
052015-05	Black 12x12 Floor Tile	Top Layer Room 131 Center	NAD
052015-06	Black 12x12 Floor Tile	Top Layer Room 131 Center	NAD
052015-07	Blk Flow Tile Mastic	Top Layer Room 131 Center	NAD
052015-08	Blk Flow Tile Mastic	Top Layer Room 131 Center	NAD
052015-09	Grey/Brown 12x12 FT	Middle Layer Room 131 NE	NAD
052015-10	Grey/Brown 12x12 FT	Middle Layer Room 131 E	NAD

NAD – No asbestos detected

NA/PS – Not analyzed, positive stop. First sample in homogenous grouping positive.

NA – Not analyzed

SUNY POTSDAM
BARRINGTON STUDENT UNION
SUMMARY OF ASBESTOS SAMPLES AND ANALYSIS RESULTS

* Samples collected as part of a contamination assessment to address an incidental disturbance in the basement. A site specific variance was developed and approved by NYSDOL. A contractor is scheduled to perform cleanup activities in April 2013.

(1) The floor tile samples collected on this date were part of an assessment for a potential incidental disturbance. The white 9x9 floor tile and mastic was discovered under the green and red floor tile (non asbestos containing) during a renovation. The green and red floor tile sampled on this date were just confirmatory samples for those previously collected on March 26, 2013 and found to be negative for asbestos. All results indicate that there was no asbestos disturbance in this area.

(2) Ambient Environmental was directed to sample 1'x1' splined ceiling tiles in Barrington Student Union. We have determined that the 1x1 splined ceiling tiles sampled and present throughout Barrington Student Union are homogeneous to one another. The samples that were collected are representative of all 1x1 splined ceiling tiles within this building. Although there are different descriptions noted in this table for each 1x1 ceiling tile collected, a NYS licensed asbestos inspector surveyed the tiles in June 2014 and has determined they are homogeneous.

SUNY POTSDAM
BARRINGTON STUDENT UNION
ASBESTOS CONTAINING MATERIALS

Sample No.	Material Description	Sample Location	Asbestos %	Homogenous Locations	Condition	Friability	Qty*
02-01	Caulking	Exterior Door	1.6% Tremolite 0.4% Chrysotile	TBD	Good	Friable	<10 sq ft
029-01	Fitting Insulation	Large Diameter in Wet Wall	7.8% Chrysotile	TBD	Good	Friable	<10 sq ft
030-01	Fitting Insulation	1" Diameter in Wet Wall	8.7% Chrysotile	TBD	Good	Friable	<10 sq ft
003-02	Debris on Floor	3 rd Floor Mechanical Room	30.8% Chrysotile	TBD	Damaged	Friable	<10 sq ft
01-01	Fire Doors	East Entry to Post Office	30.8% Amosite	TBD	Damaged	Friable	60 sq ft
01-02	Fire Doors	East Entry to Post Office	26.7% Amosite	TBD	Damaged	Friable	60 sq ft
01-03	Fire Doors	2 nd Floor Kitchen Doors	30.8% Amosite	TBD	Damaged	Friable	50 sq ft
01-04	Fire Doors	2 nd Floor Kitchen Doors	23.5% Amosite	TBD	Damaged	Friable	50 sq ft
01-05	Fire Doors	2 nd Floor Center Hallway	17.4% Amosite	TBD	Damaged	Friable	60 sq ft
01-06	Fire Doors	2 nd Floor Center Hallway	17.4% Amosite	TBD	Damaged	Friable	60 sq ft
01-01	Insulation	Steam Line-Basement	12.5% Amosite Trace Chrysotile	TBD	Significantly Damaged	Friable	
06-01	Mudded Fitting	Sewer Drain Cleanout	1.3% Amosite	TBD	Significantly Damaged	Friable	
07-01	Debris # 2 **	Debris pile #2	25.0% Amosite	TBD	Significantly Damaged	Friable	
09-01	Debris #1 **	Debris pile #1	30.8% Amosite	TBD	Significantly Damaged	Friable	
02DE-04	Debris (Elbow)	Storage By Sales Floor	6.7% Chrysotile	1 Elbow Above Ceiling Tile	Damaged	Friable	1 ln. ft.

Sample No.	Material Description	Sample Location	Asbestos %	Homogenous Locations	Condition	Friability	Qty*
0202-09	12x12 Beige Floor Tile	Store Back Entry	1.6% Chrysotile	Back Hallway of 2 nd Fl Hallway	Damaged	Non-Friable	60 sq. ft.
051409-19	Fire Door Insulation	Room 126, Door To Room 126A	33.3% Chrysotile	Room 126	Good	Non-Friable	1 Door
061412-05	Mudded Fitting	Room 130A, North West	26.7% Chrysotile	Room 130A	Good	Friable	12 LF

* Quantities are only estimates and should be field verified.

* Quantities only reflect renovation areas and do not represent other homogeneous locations throughout the school.

** Samples collected as part of a contamination assessment to address an incidental disturbance in the basement. A site specific variance was developed and approved by NYSDOL. A contractor is scheduled to perform cleanup activities in April 2013.



AmeriSci New York

117 EAST 30TH STREET
NEW YORK, NY 10016
TEL: (212) 679-8600 • FAX: (212) 679-9392

May 22, 2015

Ambient Environmental, Inc.
Attn: Joella Viscusi
12 Colvin Avenue
Albany, NY 12206

RE: Ambient Environmental, Inc.
Job Number 215053730
P.O. #150518AA
150518AA; SUNY Potsdam; Barrington Student Union Sampling, 44 Pierrepont Ave., Potsdam,
NY; Barrington Student Union - Raised Kitchen Area 131

Dear Joella Viscusi:

Enclosed are the results of Asbestos Analysis - Bulk Protocol of the following Ambient Environmental, Inc. samples, received at AmeriSci on Thursday, May 21, 2015, for a 24 hour turnaround:

01, 02, 03, 04, 05, 06, 07, 08, 09, 10, 11, 12, 13, 14

The 14 samples, placed in Zip Lock Bag, were shipped to AmeriSci via Federal Express. Ambient Environmental, Inc. requested ELAP PLM/TEM analysis of these samples.

The results of the analyses which were performed following ELAP Protocols 198.1 PLM Friable and/or 198.6 for PLM NOB. ELAP Protocol 198.4 TEM NOB guidelines are presented within the Summary Table of this report. The presence of matrix reduction data in the Summary Table normally indicates an NOB sample. For NOB samples the individual matrix reduction, combined PLM and TEM analysis results are listed in the Summary Bulk Asbestos Analysis Results in Table I. Complete PLM results for individual samples are presented in the PLM Bulk Asbestos Report. Samples near 1% asbestos may be analyzed by EPA 400 pt ct method EPA 600/M4-82-020. This combined report relates ONLY to sample analysis expressed as percent composition by weight and percent asbestos. This report must not be used to claim product endorsement or approval by these laboratories, NVLAP, ELAP or any other associated agency. This report must not be reproduced, except in full without the written approval of the laboratory. This report may contain specific data not covered by NVLAP or ELAP accreditations respectively, if so identified in relevant footnotes.

AmeriSci appreciates this opportunity to serve your organization. Please contact us for any further assistance or with any questions.

Sincerely,

A handwritten signature in blue ink, appearing to read "Paul J. Mucha".

Paul J. Mucha
Laboratory Director

**AmeriSci New York**

117 EAST 30TH ST.
NEW YORK, NY 10016
TEL: (212) 679-8600 • FAX: (212) 679-3114

PLM Bulk Asbestos Report

Ambient Environmental, Inc.
Attn: Joella Viscusi
12 Colvin Avenue

Albany, NY 12206

Date Received 05/21/15 **AmeriSci Job #** 215053730
Date Examined 05/22/15 **P.O. #**
ELAP # 11480 **Page** 1 **of** 3
RE: 150518AA; SUNY Potsdam; Barrington Student Union
Sampling, 44 Pierrepont Ave., Potsdam, NY; Barrington
Student Union - Raised Kitchen Area 131

Client No. / HGA	Lab No.	Asbestos Present	Total % Asbestos
01 052015	215053730-01 Location: Top Layer Room 131 NE - Pink 12 x 12 Floor Tile	No	NAD (by NYS ELAP 198.6) by Karol H. Lu on 05/22/15
Analyst Description: Pink, Homogeneous, Non-Fibrous, Bulk Material Asbestos Types: Other Material: Non-fibrous 48.7 %			
02 052015	215053730-02 Location: Top Layer Room 131 E - Pink 12 x 12 Floor Tile	No	NAD (by NYS ELAP 198.6) by Karol H. Lu on 05/22/15
Analyst Description: Pink, Homogeneous, Non-Fibrous, Bulk Material Asbestos Types: Other Material: Non-fibrous 53.4 %			
03 052015	215053730-03 Location: Top Layer Room 131 NE - Pink Floor Tile Mastic	No	NAD (by NYS ELAP 198.6) by Karol H. Lu on 05/22/15
Analyst Description: Tan, Homogeneous, Non-Fibrous, Bulk Material Asbestos Types: Other Material: Non-fibrous 18.3 %			
04 052015	215053730-04 Location: Top Layer Room 131 E - Pink Floor Tile Mastic	No	NAD (by NYS ELAP 198.6) by Karol H. Lu on 05/22/15
Analyst Description: Tan, Homogeneous, Non-Fibrous, Bulk Material Asbestos Types: Other Material: Non-fibrous 25.5 %			
05 052015	215053730-05 Location: Top Layer Room 131 Center - Black 12 x 12 Floor Tile	No	NAD (by NYS ELAP 198.6) by Karol H. Lu on 05/22/15
Analyst Description: Black, Homogeneous, Non-Fibrous, Bulk Material Asbestos Types: Other Material: Non-fibrous 33.3 %			

Client Name: Ambient Environmental, Inc.

PLM Bulk Asbestos Report

150518AA; SUNY Potsdam; Barrington Student Union
 Sampling, 44 Pierrepont Ave., Potsdam, NY; Barrington Student
 Union - Raised Kitchen Area 131

Client No. / HGA	Lab No.	Asbestos Present	Total % Asbestos
06 052015	215053730-06 Location: Top Layer Room 131 Center - Black 12 x 12 Floor Tile	No	NAD (by NYS ELAP 198.6) by Karol H. Lu on 05/22/15
Analyst Description: Black, Homogeneous, Non-Fibrous, Bulk Material Asbestos Types: Other Material: Non-fibrous 35.3 %			
07 052015	215053730-07 Location: Top Layer Room 131 Center - Blk. Floor Tile Mastic	No	NAD (by NYS ELAP 198.6) by Karol H. Lu on 05/22/15
Analyst Description: Tan, Homogeneous, Non-Fibrous, Bulk Material Asbestos Types: Other Material: Non-fibrous 19 %			
08 052015	215053730-08 Location: Top Layer Room 131 Center - Blk. Floor Tile Mastic	No	NAD (by NYS ELAP 198.6) by Karol H. Lu on 05/22/15
Analyst Description: Tan, Homogeneous, Non-Fibrous, Bulk Material Asbestos Types: Other Material: Non-fibrous 21.8 %			
09 052015	215053730-09 Location: Middle Layer Room 131 NE - Grey/Brown 12 x 12 FT	No	NAD (by NYS ELAP 198.6) by Karol H. Lu on 05/22/15
Analyst Description: Grey/Brown, Homogeneous, Non-Fibrous, Bulk Material Asbestos Types: Other Material: Non-fibrous 3.8 %			
10 052015	215053730-10 Location: Middle Layer Room 131 E - Grey/Brown 12 x 12 FT	No	NAD (by NYS ELAP 198.6) by Karol H. Lu on 05/22/15
Analyst Description: Grey/Brown, Homogeneous, Non-Fibrous, Bulk Material Asbestos Types: Other Material: Non-fibrous 3.8 %			
11 052015	215053730-11 Location: Middle Layer Room 131 NE - Grey/Brown FT Mastic	No	NAD (by NYS ELAP 198.6) by Karol H. Lu on 05/22/15
Analyst Description: Tan, Homogeneous, Non-Fibrous, Bulk Material Asbestos Types: Other Material: Non-fibrous 41.4 %			

Client Name: Ambient Environmental, Inc.

PLM Bulk Asbestos Report

150518AA; SUNY Potsdam; Barrington Student Union
Sampling, 44 Pierrepont Ave., Potsdam, NY; Barrington Student
Union - Raised Kitchen Area 131

Client No. / HGA	Lab No.	Asbestos Present	Total % Asbestos
12 052015	215053730-12 Location: Middle Layer Room 131 E - Grey/Brown FT Mastic	No	NAD (by NYS ELAP 198.6) by Karol H. Lu on 05/22/15
Analyst Description: Tan, Homogeneous, Non-Fibrous, Bulk Material Asbestos Types: Other Material: Non-fibrous 41.5 %			
13 052015	215053730-13 Location: Bottom Layer Room 131 NE - Linoleum Grey	No	NAD (by NYS ELAP 198.6) by Karol H. Lu on 05/22/15
Analyst Description: Grey, Homogeneous, Non-Fibrous, Bulk Material Asbestos Types: Other Material: Non-fibrous 17.9 %			
14 052015	215053730-14 Location: Bottom Layer Room 131 E - Linoleum Grey	No	NAD (by NYS ELAP 198.6) by Karol H. Lu on 05/22/15
Analyst Description: Grey, Homogeneous, Non-Fibrous, Bulk Material Asbestos Types: Other Material: Non-fibrous 15.9 %			

Reporting Notes:Analyzed by: Karol H. Lu 

*NAD/NSD =no asbestos detected; NA =not analyzed; NA/PS=not analyzed/positive stop; PLM Bulk Asbestos Analysis by EPA 600/M4-82-020 per 40 CFR 763 (NVLAP Lab Code 200546-0), ELAP PLM Method 198.1 for NY friable samples, which includes the identification and quantitation of vermiculite or 198.6 for NOB samples or EPA 400 pt ct by EPA 600/M4-82-020 (NY ELAP Lab ID11480); Note:PLM is not consistently reliable in detecting asbestos in floor coverings and similar non-friable organically bound materials. NAD or Trace results by PLM are inconclusive, TEM is currently the only method that can be used to determine if this material can be considered or treated as non asbestos-containing in NY State (also see EPA Advisory for floor tile, FR 59,146,38970,8/1/94) National Institute of Standards and Technology Accreditation requirements mandate that this report must not be reproduced except in full without the approval of the lab. This PLM report relates ONLY to the items tested. AIHA Lab # 102843, RI Cert#AAL-094, CT Cert#PH-0186, Mass Cert#AA000054.

Reviewed By:  _____ END OF REPORT _____

Client Name: Ambient Environmental, Inc.

Table I
Summary of Bulk Asbestos Analysis Results

150518AA; SUNY Potsdam; Barrington Student Union Sampling, 44 Pierrepont Ave., Potsdam, NY; Barrington Student Union - Raised Kitchen Area 131

AmeriSci Sample #	Client Sample#	HG Area	Sample Weight (gram)	Heat Sensitive Organic %	Acid Soluble Inorganic %	Insoluble Non-Asbestos Inorganic %	** Asbestos % by PLM/DS	** Asbestos % by TEM
01	01	052015	0.318	17.6	33.6	48.7	NAD	NAD
Location:	Top Layer Room 131 NE - Pink 12 x 12 Floor Tile							
02	02	052015	0.253	17.8	28.9	53.4	NAD	NAD
Location:	Top Layer Room 131 E - Pink 12 x 12 Floor Tile							
03	03	052015	0.208	67.8	13.9	18.3	NAD	NAD
Location:	Top Layer Room 131 NE - Pink Floor Tile Mastic							
04	04	052015	0.188	57.4	17.0	25.5	NAD	NAD
Location:	Top Layer Room 131 E - Pink Floor Tile Mastic							
05	05	052015	0.300	19.0	47.7	33.3	NAD	NAD
Location:	Top Layer Room 131 Center - Black 12 x 12 Floor Tile							
06	06	052015	0.391	18.9	45.8	35.3	NAD	NAD
Location:	Top Layer Room 131 Center - Black 12 x 12 Floor Tile							
07	07	052015	0.184	70.1	10.9	19.0	NAD	NAD
Location:	Top Layer Room 131 Center - Blk. Floor Tile Mastic							
08	08	052015	0.234	70.5	7.7	21.8	NAD	NAD
Location:	Top Layer Room 131 Center - Blk. Floor Tile Mastic							
09	09	052015	0.286	16.4	79.7	3.8	NAD	NAD
Location:	Middle Layer Room 131 NE - Grey/Brown 12 x 12 FT							
10	10	052015	0.293	15.7	80.5	3.8	NAD	NAD
Location:	Middle Layer Room 131 E - Grey/Brown 12 x 12 FT							
11	11	052015	0.215	52.1	6.5	41.4	NAD	NAD
Location:	Middle Layer Room 131 NE - Grey/Brown FT Mastic							
12	12	052015	0.135	41.5	17.0	41.5	NAD	NAD
Location:	Middle Layer Room 131 E - Grey/Brown FT Mastic							
13	13	052015	0.195	40.0	42.1	17.9	NAD	NAD
Location:	Bottom Layer Room 131 NE - Linoleum Grey							
14	14	052015	0.201	38.8	45.3	15.9	NAD	NAD
Location:	Bottom Layer Room 131 E - Linoleum Grey							

See Reporting notes on last page

Client Name: Ambient Environmental, Inc.

Table I

Summary of Bulk Asbestos Analysis Results

150518AA; SUNY Potsdam; Barrington Student Union Sampling, 44 Pierrepont Ave., Potsdam, NY; Barrington Student Union - Raised Kitchen Area 131

AmeriSci Sample #	Client Sample#	HG Area	Sample Weight (gram)	Heat Sensitive Organic %	Acid Soluble Inorganic %	Insoluble Non-Asbestos Inorganic %	** Asbestos % by PLM/DS	** Asbestos % by TEM
----------------------	----------------	------------	----------------------------	--------------------------------	--------------------------------	--	----------------------------	-------------------------

Analyzed by: Marik Peysakhov; Date Analyzed 5/22/2015

**Quantitative Analysis (Semi/Full): Bulk Asbestos Analysis - PLM by EPA 600/M4-82-020 per 40 CFR or ELAP 198.1 for New York friable samples or ELAP 198.6 for New York NOB samples; TEM (Semi/Full) by EPA 600/R-93/116 (not covered by NVLAP Bulk accreditation) or ELAP 198.4; for New York samples; NAD = no asbestos detected during a quantitative analysis; NA = not analyzed; Trace = <1%; Quantitation for beginning weights of <0.1 grams should be considered as qualitative only; Qualitative Analysis: Asbestos analysis results of "Present" or "NVA = No Visible Asbestos" represents results for Qualitative PLM or TEM Analysis only (no accreditation coverage available from any regulatory agency for qualitative analyses); AIHA Lab # 102843, NVLAP Lab Code 200546-0, NYSDOH ELAP Lab ID#11480.

Warning Note: PLM limitation, only TEM will resolve fibers <0.25 micrometers in diameter. TEM bulk analysis is representative of the fine grained matrix material and may not be representative of non-uniformly dispersed debris for which PLM evaluation is recommended (i.e. soils and other heterogeneous materials).

Reviewed By: 



Ambient Environmental, Inc.
Comprehensive Building Science Solutions
12 Colvin Ave. Albany, NY 12206
PH: 518-482-0704 | FX: 518-482-0750

#215053730

BULK SAMPLE DATA AND
CHAIN OF CUSTODY FORM

PROJECT INFORMATION

1. Client: SUNY Potsdam	2. Project Name: Barrington Student Union	2a. Project Address: 44 Piermont Ave Potsdam, NY	2b. Client Contact: Larry Leashomb
3. Project Number: 150518AA	3a. Task Number:	4. Inspector: Matthew Weeks	5. Collection Date: 5/20/15
6. Sample TAT: <input checked="" type="checkbox"/> 24 HR <input type="checkbox"/> 48 HR <input type="checkbox"/> 72 HR <input type="checkbox"/> 5 Day <input type="checkbox"/> Other	7. Building Name: Barrington Student Union	8. Sampling Areas: Revised Kitchen Area 131 (see map)	9. Comments: (Field) <input checked="" type="checkbox"/> Analyze to First Positive By Homogeneous Material <input checked="" type="checkbox"/> For Negative NOB PLM's, continue to TEM

TYPE OF MATERIALS

10. Laboratory Sample Number	11. Homogeneous Area Number	12. Bulk Sample ID Number	13. Sampled Material	14. Type of Material			15. Sample Location		16. Friability (N/F)	17. Condition (G, D, SD)	18. Quantity (LF, SF, EA)	19. Asbestos Content (Type & %)
				Surf	TSI	MISC	Sample Coordinates					
	052015	01	Pink 12x12 Floor Tile			✓	Top layer Room 131 NE		N	SD	200 SF	
	052015	02	"			✓	Top layer Room 131 E		N	SD	200 SF	
	052015	03	Pink Floor Tile Mosaic			✓	Top layer Room 131 NE		N	SD	200 SF	
	052015	04	"			✓	Top layer Room 131 E		N	SD	200 SF	
	052015	05	Black 12x12 Floor Tile			✓	Top layer Room 131 Center		N	G	200 SF	
	052015	06	"			✓	Top layer Room 131 Center		N	G	200 SF	
	052015	07	Blk Floor Tile Mosaic			✓	Top layer Room 131 Center		N	G	200 SF	
	052015	08	"			✓	Top layer Room 131 Center		N	G	200 SF	
	052015	09	Grey/Brown 12x12 FT			✓	Middle layer Room 131 NE		N	G	200 SF	
	052015	10	"			✓	Middle layer Room 131 E		N	G	200 SF	
	052015	11	Grey/Brown FT Mosaic			✓	Middle layer Room 131 NE		N	G	200 SF	
	052015	12	"			✓	Middle layer Room 131 E		N	G	200 SF	
	052015	13	Linoleum Grey			✓	Bottom layer Room 131 NE		N	G	200 SF	
	052015	14	"			✓	Bottom layer Room 131 E		N	G	200 SF	

CHAIN OF CUSTODY

CHAIN OF CUSTODY

20. Relinquished By:	21. Date:	22. Time:	23. Received By:	24. Date:	25. Time:
I [Signature]	5/20/15		Catherine Arns	5/21/15	7:35
II					
III					

LAB INFORMATION

26. Lab Name	27. Date	28. Time
a. Analyzed By: KAROL LV (P41)	05/22/15	8:53
b. Lab Batch #	5/22/15	12:23

29. Ambient Project Manager:

[Signature]

30. Results To: results@ambient-env.com

Ernesto 1433@aol.com

31. Drawings:

☒ Sample Locations
☒ Material Locations

32. Comments:

DGS Notes

3/98

Asbestos Containing
Material Locations

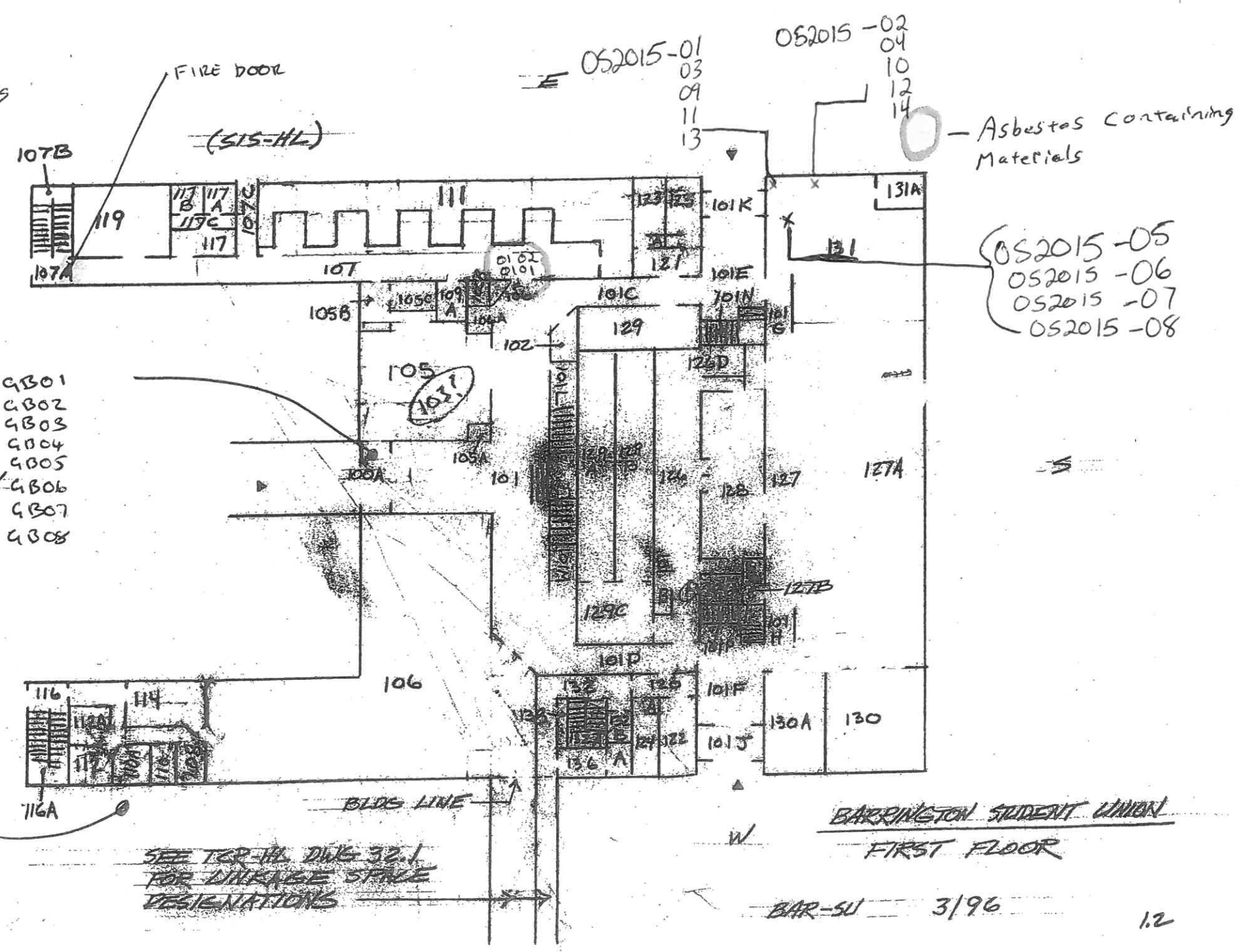

BARRINGTON STUDENT UNION
FIRST FLOOR

BAR-SU 3/96

1.2

New York State - Department of Labor

Division of Safety and Health
License and Certificate Unit
State Campus, Building 12
Albany, NY 12240

ASBESTOS HANDLING LICENSE

Ambient Environmental, Inc.

12 Colvin Avenue

Albany, NY 12206

FILE NUMBER: 06-0549

LICENSE NUMBER: 28608

LICENSE CLASS: RESTRICTED

DATE OF ISSUE: 07/16/2014

EXPIRATION DATE: 07/31/2015

Duly Authorized Representative - Joella Visconti

This license has been issued in accordance with applicable provisions of Article 30 of the Labor Law of New York State and of the New York State Codes, Rules and Regulations (12 NYCRR Part 56). It is subject to suspension or revocation for a (1) serious violation of state, federal or local laws with regard to the conduct of an asbestos project, or (2) demonstrated lack of responsibility in the conduct of any job involving asbestos or asbestos material.

This license is valid only for the contractor named above and this license or a photocopy must be prominently displayed at the asbestos project worksite. This license verifies that all persons employed by the licensee on an asbestos project in New York State have been issued an Asbestos Certificate, appropriate for the type of work they perform, by the New York State Department of Labor.

Ellen M. Franko

SH 432 (8/12)

Ellen M. Franko, Acting Director
For the Commissioner of Labor

Empire State Development

December 10, 2014

File ID: 50943

Ms. Joella Viscusi
Ambient Environmental Inc.
12 Colvin Avenue
Albany, NY 12206

Dear Ms. Joella Viscusi:

The New York State Department of Economic Development, Division of Minority and Women's Business Development (DMWBD) has determined that your firm, Ambient Environmental Inc., continues to meet eligibility requirements for re-certification, pursuant to Executive Law, Article 15-A and 5NYCRR Section 140 through 145 of the Regulations.

Therefore, we are pleased to inform you that your firm, has once again, been granted status as a **Women Business Enterprise (WBE)**. Your business will continue to be listed in the State's Directory of Certified Businesses with codes listed on the following page.

This Certification remains in effect for a period of generally three (3) years from the date of this letter or until such time as you are selected again, by this office for re-certification. Any changes in your company that affect ownership, managerial and/or operational control, must be reported to this Office within thirty (30) days of such changes; including changes to company name, business address, telephone numbers, principal products/services and bonding capacity.

The Certification status is not intended to imply that New York State guarantees your company's capability to perform on contracts, nor does it imply that your company is guaranteed any State business.

Thank you for your cooperation. On behalf of the State of New York, I wish you luck in your business endeavors, particularly those involving State agencies.

Sincerely,



Bette Yee
Director of Certification Operations



New York State Department of Economic Development
633 Third Avenue New York New York 10017 Tel 212 803 2414
Web Site: www.esd.ny.gov/MWBE/html

December 10, 2014

File ID: 50943

Ms. Joella Viscusi
Ambient Environmental Inc.
12 Colvin Avenue
Albany, NY 12206

Ambient Environmental Inc. will be listed in the State's Directory of Certified Businesses with the following list of codes for products and services:

ESD-C-0029: ASBESTOS REMOVAL
ESD-I-0246: ENVIRONMENTAL CONSULTANTS
ESD-I-1072: ASBESTOS ABATEMENT & COMPLIANCE
ESD-I-2070: ASBESTOS ABATEMENT PLANS & COMPLIANCE
ESD-I-2072: LEAD PAINT ABATEMENT PLANS & COMPLIANCE
ESD-I-2429: LEAD INSPECTION & RISK ASSESSMENT
NAICS-562910: ASBESTOS ABATEMENT SERVICES
NAICS-562910: ASBESTOS REMOVAL CONTRACTORS



STATE OF NEW YORK
DEPARTMENT OF TRANSPORTATION
ALBANY, N.Y. 12232
www.nysdot.gov

JOAN McDONALD
COMMISSIONER

ANDREW M. CUOMO
GOVERNOR

MAR 27 2013
Ms. Joella Viscusi, President
Ambient Environmental, Inc.
12 Colvin Avenue
Albany, NY 12206

Re: DBE CERTIFICATION NOTICE

Dear Ms. Viscusi:

The New York State Department of Transportation (NYSDOT), a Certifying Partner in the New York State Unified Certification Program (NYSUCP), is pleased to inform you that your firm meets the eligibility criteria established by the U.S. Department of Transportation Disadvantaged Business Enterprises regulation, codified at 49 CFR, Part 26, and has been **CERTIFIED** as a Disadvantaged Business Enterprise (DBE) with the NYSUCP. Your firm is certified to provide the services listed below:

Area of Service: Environmental & Sanitation Consulting Services

NAICS:

541620 Environmental Consulting Services

NYSDOT Codes:

080B Air Quality
080E Noise
080H Hazardous Waste/Asbestos/Lead

Your firm is eligible to participate as a DBE on NYSDOT, Metropolitan Transportation Authority, Port Authority of New York and New Jersey and Niagara Frontier Transportation Authority federally assisted projects in the identified service areas.

Your firm's certification status with the NYSUCP will remain effective for as long as your firm continues to meet all DBE certification eligibility requirements and the ownership and control of the firm, upon which DBE certification was granted, has not changed. However, you are required to submit, annually, on the anniversary date of this notice, a sworn affidavit affirming that there have been no changes in your firm's economic disadvantaged status,

ownership or control. In the event that there are changes, please be advised that you are required to notify the NYSDOT, within 30 days, of any changes in your business' ownership, control and/or operations including address, telephone number, business services and capabilities. Failure to adhere to these requirements may result in the removal of DBE certification.

Your firm will be included in the NYSUCP Directory (<http://biznet.nysucp.net>) which will indicate the type of work that your firm has been certified to perform.

Please note that any of the Certifying Partners of the NYSUCP reserves the right to review your firm's certification eligibility prior to your firm's participation on a federally assisted project for their agency or at any time that it is determined that such reevaluation is warranted.

As a newly certified DBE highway and bridge construction contractor, you are eligible to receive a free one-year subscription to Bid Express (Bid-X). Bid-X is a Web-based subscription service that provides for the electronic submission of contract bids by contractors for NYSDOT contracts. To learn more about the features and benefits of Bid-X, please contact NYSDOT Office of Civil Rights at OCR-SBN@dot.state.ny.us.

Furthermore, as a newly certified DBE you should be aware that the U.S. Small Business Administration (SBA) can guarantee bonds for contracts up to \$2 million, covering bid, performance and payment bonds for small and emerging contractors who cannot obtain surety bonds through regular commercial channels. To learn more about the Surety Bond Guarantee Program, please call 800-U-ASK-SBA (800-827-5722) or visit <http://www.sba.gov/index.html>.

We are pleased to have you as a participant in the NYSUCP and wish you much success.

Should you have any questions, please email Lory.Smitka@dot.ny.gov, or call (518) 457-3180.

Sincerely,

Lory Smitka

Lory Smitka
Compliance Specialist 1
DBE Certification
Office of Audit

STATE OF NEW YORK - DEPARTMENT OF LABOR
ASBESTOS CERTIFICATE



MATTHEW E WEEKS
CLASS(EXPIRES)
C ATEC(06/16) D INSP(06/16)
H PM (06/16)

CERT# 17-01735
DMVR 424607250

MUST BE CARRIED ON ASBESTOS PROJECTS



01213 000524542 85

EYES BLU
HAIR BRO
HGT 5' 07"

IF FOUND RETURN TO:
NYSDEL - L&C UNIT
ROOM 161A BUILDING 12
STATE OFFICE CAMPUS
ALBANY NY 12240

NEW YORK STATE DEPARTMENT OF HEALTH
WADSWORTH CENTER



Expires 12:01 AM April 01, 2016
Issued April 01, 2015

CERTIFICATE OF APPROVAL FOR LABORATORY SERVICE

Issued in accordance with and pursuant to section 502 Public Health Law of New York State

MR. PAUL J. MUCHA
AMERICA SCIENCE TEAM NEW YORK INC
117 EAST 30TH ST
NEW YORK, NY 10016

NY Lab Id No: 11480

*is hereby APPROVED as an Environmental Laboratory for the category
ENVIRONMENTAL ANALYSES SOLID AND HAZARDOUS WASTE
All approved subcategories and/or analytes are listed below:*

Miscellaneous

Asbestos in Friable Material	Item 198.1 of Manual EPA 600/M4/82/020
Asbestos in Non-Friable Material-PLM	Item 198.6 of Manual (NOB by PLM)
Asbestos in Non-Friable Material-TEM	Item 198.4 of Manual

Serial No.: 52773

Property of the New York State Department of Health. Certificates are valid only at the address shown, must be conspicuously posted, and are printed on secure paper. Continued accreditation depends on successful ongoing participation in the Program. Consumers are urged to call (518) 485-5570 to verify the laboratory's accreditation status.